

2022

Emergency Shoulder Use Standard Operating Procedure

**SR-528 WESTBOUND - SR-407 TO SR-417
(ESU) CONCEPT 2021
(RIGHT SHOULDER USE ONLY)**

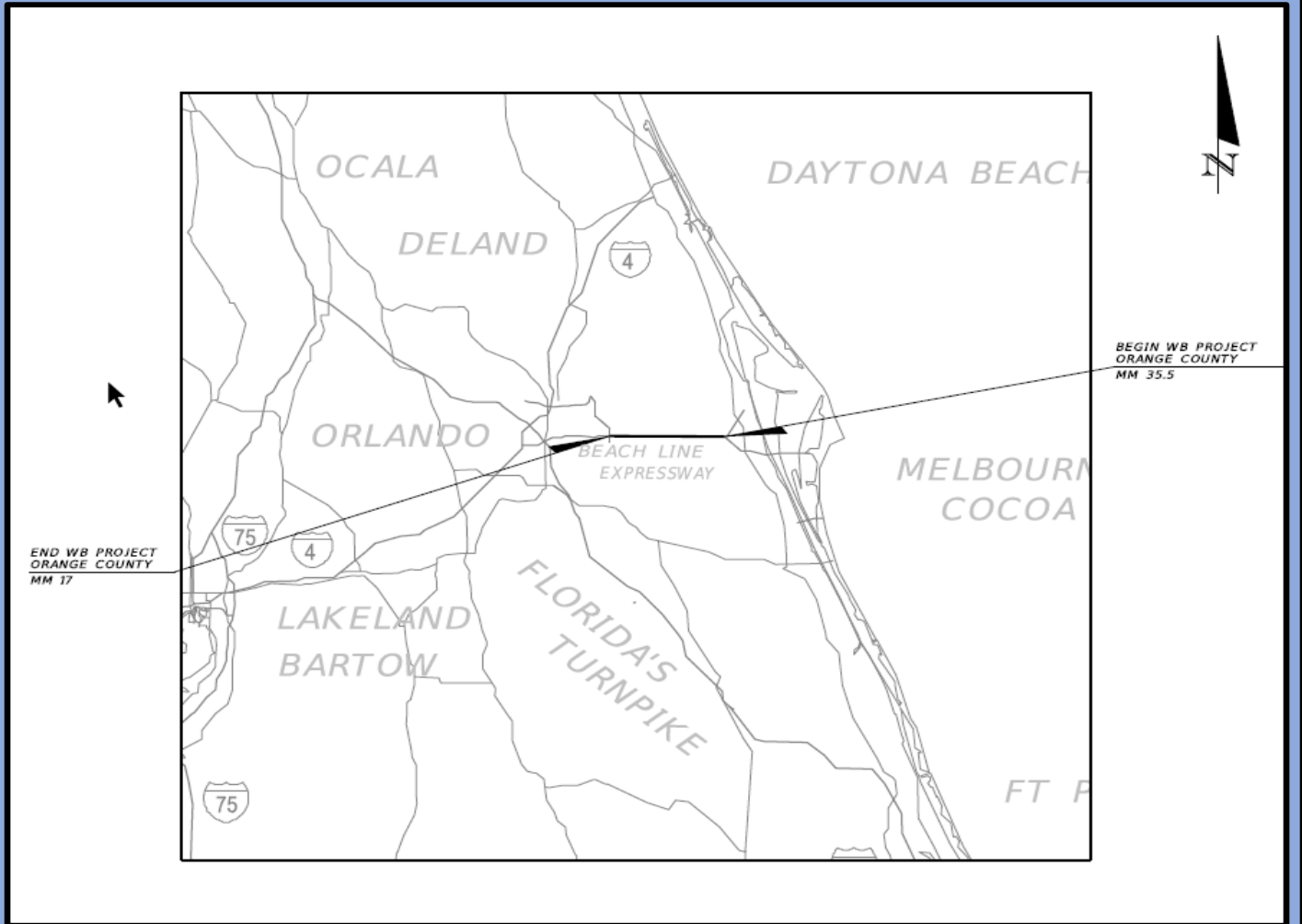

CONTENTS

DISTRICT FIVE SR 528 CORRIDOR: SR 407 TO SR 417	3
ORGANIZATION STRUCTURE AND COMMUNICATION	4
EMERGENCY SHOULDER USE – OPERATIONAL FLOW CHART	4
CONTACT LIST.....	5
ANNUAL PREPAREDNESS OPERATIONS UNDER BLUE SKIES.....	8
PRE-IMPLEMENTATION OPERATIONS UNDER PENDING GRAY SKIES	9
IMPLEMENTATION OPERATIONS	11
SET-UP	13
DURATION.....	13
POST IMPLEMENTATION OPERATIONS	15
POST EVENT OPERATIONS	16
ATTACHMENT A: LIST OF ACRONYMS.....	17
ATTACHMENT B: SIGN TABLE.....	18
ATTACHMENT C: SIGN AND LEO LOCATION EXAMPLE	19
ATTACHMENT D: PRECAUTIONS FOR SAFETY SERVICE PATROLS	20

This document Revision 2, 5/6/22.

Confidential and Exempt Pursuant to F.S. 119.071.

Do not copy, distribute, or release without written permission of District Five Maintenance Engineer.

Emergency Shoulder Use Standard Operating Procedure

DISTRICT FIVE SR 528 CORRIDOR: SR 407 TO SR 417

This Standard Operating Procedure (SOP) establishes the operations required to be prepared for and to implement Emergency Shoulder Use (ESU) as shown in the ESU Concept Plans for SR 528 Westbound between SR 407 MM 35.5 in Orange County to SR 417 in Orange County MM 17, totaling 18.5 miles. The implementation of ESU requires the coordinated effort of the Florida Department of Transportation (FDOT), Florida Turnpike Enterprise (FTE), Central Florida Expressway Authority (CFX), Florida Highway Patrol (FHP), and other law enforcement agencies and contracting partners. This SOP establishes what operations must be performed and by whom, when the operations will be performed, where the operations will be performed, and how the operations will be performed. This SOP may be revised. The ability to adapt to actual conditions is a necessity during any emergency event.

The purpose of the ESU plan is to serve as a tool to help evacuate a region due to or in advance of a natural or man-made disaster. It is designed to temporarily increase the roadway capacity and **is intended to be a 24-hour operation**. The current ESU Concept Plans show the typical location for traffic control channelizing devices, Law Enforcement Officers (LEO), narrow shoulder locations and emergency crossover locations.

ORGANIZATION STRUCTURE AND COMMUNICATION

An Area Command (AC) is the appropriate Incident Command System (ICS) organizational structure for this SOP. Terms and concepts from the National Incident Management System (NIMS) and ICS standardized systems are used in this SOP without elaboration. Please refer to an appropriate NIMS or ICS document for further explanation of any unfamiliar terms and/or conditions. See Attachment A for a list of acronyms for this SOP.

FDOT and FHP will implement Emergency Shoulder Use (ESU) following direction from the Governor or State Coordinating Officer. The FDOT will provide the direction to implement ESU from the State Emergency Operations Center (SEOC) to the FDOT District 5 EOC. FHP will provide the direction using a similar process. At that point, coordination, and implementation of ESU will be at the District and Troop level.

The Area Commander (AC) is responsible for providing overall direction on pre-event preparation, ensuring that all parties perform assignments and report status as required. The FDOT D5 Maintenance Engineer shall be designated as the AC. The D5 Operations Section chief shall be responsible for the overall implementation of ESU along this corridor. The individuals assigned to the Operations Section Chief position are identified in the FDOT D5 EOC Organization Chart.

Notifications and orders to implement will be given to the Asset Maintenance Contractors (AMC) and all other personnel and Contractors deemed necessary by the AC or designee. The portion of SR 528 between SR 417 and SR 520 is owned and operated by the Central Florida Expressway Authority, applicable CFX contacts will apply to this section of roadway. Notification to appropriate personnel will be made via telephone, e-mail, fax, radio, etc.

EMERGENCY SHOULDER USE – OPERATIONAL FLOW CHART

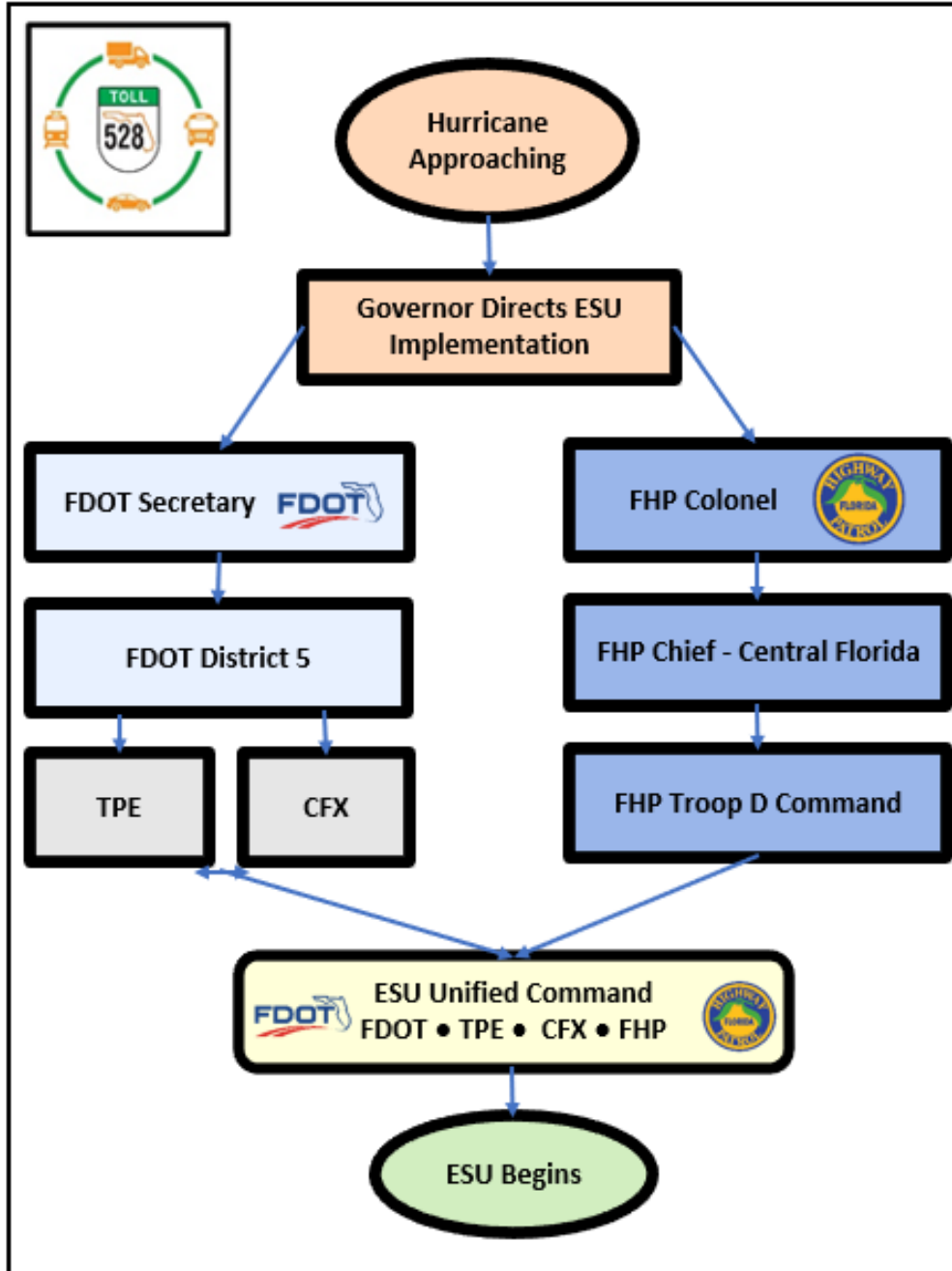

PRIMARY NOTIFICATION

- Florida Department of Transportation – District Five (D5)
- Florida’s Turnpike Enterprise (FTE)
- Florida Highway Patrol (FHP) Command Center – Troop D
- Central Florida Expressway (CFX)
- Asset Maintenance Contractors (CMTI)
- County Emergency Management Office – Orange County
- Communications Office – News Media

CONTACT LIST

(Not for public distribution)

Name	Agency	Email	Phone
Ron Meade	FDOT D5 DECO, DME	ron.meade@dot.state.fl.us	386-956-8959
Dennis Kirk	FDOT D5 Deputy DM Admin.	dennis.kirk@dot.state.fl.us	386-279-5476
Blake Baker	FDOT D5 EM Specialist	blake.baker@dot.state.fl.us	386-801-8996
District Five (D5) EOC	FDOT D5	d5-eoc@dot.state.fl.us	386-943-5740
Jim Stroz	FDOT D5 Traffic Ops	jim.stroz@dot.state.fl.us	386-943-5309
RTMC D-5	FDOT D5 Traffic Ops	d5.rtmc@dot.state.fl.us	407-736-1900
Sheryl Bradley	Traffic Incident Management	sheryl.bradley@dot.state.fl.us	321-300-5846
Jim Wood	FDOT D5 Oviedo Ops	jim.wood@dot.state.fl.us	407-496-5703
Mike Danos	FDOT D5 Oviedo Ops	mike.danos@dot.state.fl.us	407-335-3900
Assaad Saliba	FDOT D5 Orlando Ops	assaad.saliba@dot.state.fl.us	407-496-5690
Seta Koroitamudu	FDOT D5 Orlando Ops	seta.koroitamudu@dot.state.fl.us	407-558-8168
Suzanne Phillips	FDOT D5 Brevard Ops	Suzanne.phillips@dot.state.fl.us	386-279-2953
Jonathan Morgans	D5 AM Contractor (CMTI)	jmorgans@cmtfl.com	321-634-6062
Sly Bray	D5 AM Contractor (CMTI)	sbray@cmtfl.com	321-604-9612
Maj Chris Blackmon	FHP Troop D Commander	chrisblackmon@flhsmv.gov	407-737-2300
Capt. Christopher Sorvillo	FHP Troop D	christophersorvillo@flhsmv.gov	321-200-5464
Donald Budnovich	CFX Maintenance & Road Rangers	donald.budnovich@cfxway.com	321-662-0750
Bryan Homayouni	CFX Traffic Operations	bryan.homayouni@cfxway.com	407-284-9376

Matthew Lewis	CFX Maintenance	matthew.lewis@cfxway.com	407-467-8861
James Martin	CFX Maintenance	james.martin@cfxway.com	407-625-0276
Debbie Meyer	FDOT FTE DME	debbie.meyer@dot.state.fl.us	954-934-1228
John Easterling	FDOT FTE DTOE	john.easterling@dot.state.fl.us	954-553-0462
Douglas Prager	FDOT FTE EM	douglas.prager@dot.state.fl.us	954-444-0333
Mike Washburn	FDOT FTE TMC	michael.washburn@dot.state.fl.us	954-809-1610

EQUIPMENT LIST

Temporary static signs will be used that are fluorescent pink color panels with black border, symbols, and lettering.

TABULATION OF QUANTITIES						
LOCATIONS	NUMBER	LAW ENFORCEMENT OFFICER (LEO)	EMERGENCY ASSISTANCE VEHICLE (EAV)	PORTABLE CHANGEABLE MESSAGE SIGN (PCMS)	TEMP. STATIC SIGN	CHANNELIZING DEVICES
BEGIN	1	1	1	2	1	0
END	1	1	1	2	7	11
INTERCHANGE	3	6	3	2	18	146
TOLL PLAZA	1	1	1	2	2	105
NARROW SHOULDER	4	0	0	0	12	0
TOTAL		9	6	8	40	278

See Attachment B for the road sign table (to be updated after sign installation).

DYNAMIC MESSAGE SIGN (DMS)				
NO.	DISTRICT	COUNTY	LOCATION	MILE MARKER
1	5	ORANGE	E. OF SR 520	31.7
2	5	ORANGE	W. OF DALLAS BLVD	23.3

TOLL DYNAMIC MESSAGE SIGN (TDMS)				
NO.	DISTRICT	COUNTY	LOCATION	MILE MARKER
1	5	ORANGE	TDMS E. OF TOLL PLAZA	26.5
2	5	ORANGE	TDMS E. OF TOLL PLAZA	26.3
3	5	ORANGE	TDMS E. OF TOLL PLAZA	17.5
4	5	ORANGE	TDMS E. OF TOLL PLAZA	17.3

ANNUAL PREPAREDNESS OPERATIONS UNDER BLUE SKIES

The Preparedness Operations phase considers what tasks need to occur prior to Hurricane Season each year. All Maintenance Contractor activities will be performed to MRP standards per their contracts. The status of all tasks will be discussed at the monthly progress meetings and included in the contractor's monthly activity report.

FTE & CFX areas of responsibility are outlined in the MOU. FDOT will assume responsibility for all FTE activities identified in the Blue Skies/Grey Skies tables below until 6/30/22.

Pre-Implementation	Responsible Party	Timeline	Quality Control
Verify that all ITS are functioning	RTMC	Prior to June 1	Traffic Operations
Ensure temporary signs and PCMS Equipment are available and ready	FDOT / FTE	Prior to June 1	FDOT / FTE AM Contract Manager & Inspector
Check shoulder conditions to ensure that drop off standards are meeting MRP requirements	FTE / CFX	Prior to June 1	FTE / CFX AM Contract Manager & Inspector
Check for potholes and repair to meet MRP requirements	FTE / CFX	As needed prior to June 1	FTE / CFX AM Contract Manager & Inspector
Remove Vegetation to meet MRP requirements	FTE / CFX	Quarterly and immediately prior to implementation of ESU	FTE / CFX AM Contract Manager & Inspector
Remove Litter to meet MRP criteria along the entire corridor. (Include excess debris under guardrail)	FTE / CFX	Routinely throughout the year	FTE / CFX AM Contract Manager & Inspector
Remove Encroachments to meet MRP requirements	FTE / CFX	Routinely throughout the year / immediately prior to implementation of ESU	FTE / CFX AM Contract Manager & Inspector
Sweep the Shoulders to remove all loose materials and small debris	FTE / CFX	Monthly during hurricane season. Immediately prior to implementation of ESU	FTE / CFX AM Contract Manager & Inspector
Ensure Guardrail meets MRP criteria along the entire corridor	FTE / CFX	Routinely throughout the year	FTE / CFX AM Contract Manager & Inspector
Ride the Corridor	FDOT / FTE / CFX	Prior to June 1 and immediately prior to implementation of ESU	FDOT / FTE / CFX
Coordinate with FHP	FDOT / FTE	Prior to June 1	FDOT DME

Coordinate with Local Agency Partners	FDOT	Prior to June 1	FDOT DME
Coordinate with social media, Local News Partners	FDOT / FTE / CFX PIO Offices	Prior to June 1 and immediately prior to implementation of ESU	FDOT DME
Schedule and hold exercises for coordination efforts with FHP, CFX, FTE, and Asset Maintenance Contractors.	FDOT	Exercise as needed.	FDOT DME
Monitor upcoming and on-going construction work.	FDOT / FTE / CFX	Prior to and throughout Hurricane season / Identify in Concept Plans	FDOT DME
Coordinate with Decision Makers	FDOT / FTE / CFX	On-Going	FDOT DME

PRE-IMPLEMENTATION OPERATIONS UNDER PENDING GRAY SKIES

Pre-Implementation Operation Activity (Pending Gray Skies)	Responsible Party	Location	Timeline - When	Timeline - Duration	Quality Control
Verify that all ITS are functioning	RTMC	Along the corridor	5 to 7 days out		Traffic Operations
Pre-Storm Meeting with AM Contractor	FDOT / FTE / CFX		5 to 7 days out		FDOT
Remove Vegetation to meet MRP criteria adjacent to ESU (including vegetation under guardrail)	FTE / CFX	Entire Corridor Length	5 to 7 days out	2 days	FTE / CFX AM Contract Manager & Inspector
Remove Litter to meet MRP criteria along the entire corridor. (Include excess debris under guardrail)	FTE / CFX	Entire Corridor Length	5 to 7 days out	2 days	FTE / CFX AM Contract Manager & Inspector
Ensure Guardrail meets MRP criteria along the entire corridor	FTE / CFX	Entire Corridor Length	5 to 7 days out	2 days	FTE / CFX AM Contract Manager & Inspector
Remove Encroachments to meet MRP requirements	FTE / CFX	Entire Corridor Length	5 to 7 days out	3 days	FTE / CFX AM Contract Manager & Inspector
Number of EAV's and staging locations will be shown in the AM Contractor Emergency Plan	FDOT / FTE	As defined along corridor	2 days out		DME / RTMC

Deploy Portable Changeable Message Signs	FDOT LMU / FTE	Per plan & SOP Attachment B sign table	Implementation of ESU is anticipated	6 hours	FDOT / FTE
Sweep the shoulders to remove all loose materials and small debris	FTE / CFX	Entire Corridor Length	Implementation of ESU is anticipated	2 days	FTE / CFX AM Contract Manager & Inspector
Notify FHP for removal of Abandoned Vehicles	FTE / CFX	Entire Corridor Length	Implementation of ESU is anticipated	8 – 12 hours	FTE / CFX AM Contract Manager & Inspector
Ride the Corridor	FDOT / FTE / CFX	Entire Corridor Length	Implementation of ESU is anticipated	4 hours	FDOT / FTE / CFX
Coordinate with social media, Local News Partners	FDOT / FTE / CFX PIO Offices	Entire Corridor Length	Implementation of ESU is	On-Going	DME

PUBLIC INFORMATION: FDOT D5, FTE, FHP, and CFX, Communications Offices will constantly provide updated information to radio, TV, news media, and local authorities, prior to, during, and after the operation. This will be accomplished by the preparation of news releases and dissemination to appropriate news media on a timely basis.

The Regional Traffic Management Center (RTMC) will post messages on the Dynamic Message Signs (DMS) signs and 511.

LOGISTICS: The implementation of ESU requires a coordinated effort between the FDOT, FTE, CFX, FHP, and county and local officials. The RTMC will keep the FDOT D5 EOC informed of traffic conditions and assist with coordination of Road Ranger response efforts.

DEPLOY THE PORTABLE CHANGEABLE MESSAGE SIGNS (PCMS): FDOT/FTE/AMC will transport the PCMS to the designated locations and set up according to standards. The PCMS panels shall display the message “Drive Safely” and the operation of the unit including the appropriate message will be re-checked.

REFUELING SITES FOR STATE VEHICLES: Fuel for state vehicles will be obtained at commercial gas stations or at local FDOT facilities. Additionally, there may be fuel tankers positioned at strategic locations along the route if determined necessary.

EQUIPMENT STAGING SITES: Equipment and supplies will be maintained and provided by the appropriate AMC. Once information is received that ESU procedures are to be implemented, the equipment will be transported by the AMC to the staging site to await deployment.

DISABLED VEHICLES AND MOTORISTS OF DISABLED VEHICLES: EAV shall patrol the roadway and will be used to remove and repair disabled vehicles and to transport motorists of disabled vehicles to the nearest commercial facility to ensure the free flow of traffic as much as possible. Motorists should be advised by news media to have a full tank of fuel prior to entering the interstate.

EMERGENCY MEDICAL SERVICES: Emergency Medical Services (EMS) will be advised upon the implementation of ESU operations. Due to the shoulders for evacuation, there may be a need to pre-stage emergency equipment.

COMMUNICATIONS: FDOT D5 EOC will serve as the central point of coordination. Communication will be maintained throughout pre-implementation operations under pending gray skies with the following:

FDOT Central Office

FDOT Communications Office

Florida Highway Patrol

Asset Maintenance Contractor / Roadside Assistance Services Contractor

CFX

FTE

IMPLEMENTATION OPERATIONS

Upon notification to implement ESU with confirmation through the District Secretary, the AC will begin notifications and direct the Operations Section Chief to begin implementation. Working from west to east, the AMC shall implement ESU within 4 hours after the order has been given.

The AMC will closely coordinate their efforts to ensure that the shoulders are not opened to traffic prior to the shoulders being cleared by both contractors. Once the AMC has flipped all appropriate signage, they will program the appropriate message on the PCMS and open the shoulder to traffic.

Implementation Operations	Responsible Party	Location	Timeline (When)	Timeline (How Long)	Quality Control
Deploy PCMS, Traffic Control Devices, Temporary Signs	FDOT LMU / FTE	Per Plans and SOP Equipment List	Implementation of ESU	4-hour prior	FDOT LMU / FTE AMC Contract Manager & Inspector
Set and display messages on Portable Changeable Message Signs & DMS	FDOT LMU / FTE	Per Plans & SOP Equipment List	Implementation of ESU	1-hour prior	FDOT LMU / FTE AMC Contract Manager & Inspector
Ride the Corridor	FDOT LMU / FTE	Entire Corridor Length	Implementation of ESU	4 hours prior	FDOT LMU / FTE AMC Contract Manager & Inspector
Coordinate with law enforcement agencies	FDOT / FTE	Entire Corridor Length	Implementation of ESU	On-Going during	DME
Monitor ITS for any adjustments needed	FDOT / FTE	Entire Corridor Length	Prior to and during Implementation of ESU	On-Going during	DME / RTMC
Positioning of LEO and EAV	FDOT / FTE / RTMC	Entire Corridor Length	Implementation of ESU	On-Going during	DME / RTMC
Deployment of Roadside Assistance	FDOT / FTE / RTMC	Entire Corridor Length	Implementation of ESU	On-Going during	DME / RTMC
Coordinate with Local Agency Partners	FDOT D5 EOC	Entire Corridor Length	Implementation of ESU	On-Going during	DME
Coordinate with social media, local news partners	FDOT / FTE / CFX PIO Offices	Entire Corridor Length	Implementation of ESU	On-Going during	DME
Coordinate with Decision Makers	FDOT / FTE / CFX	Entire Corridor Length	Implementation of ESU	On-Going	DME

SET-UP

The FDOT D5 EOC will serve as the central point of coordination. Communication will be maintained throughout the ESU with the following:

Florida Highway Patrol

Florida Department of Transportation Central Office

Asset Maintenance Contractor / Roadside Assistance Services Contractor

FDOT Communications Office

CFX

TPE

DEPLOY RESOURCES: The order to deploy personnel and equipment resources will be given by the AC. When the order to deploy is given, the Operations Chief will task the AMC to deploy resources. The AMC will deploy resources to their designated locations immediately upon notification. Set-up time is estimated at 4 hours.

VERIFY DEPLOYMENT: AMC and FHP will notify the District Five Operations Chief when resource deployment verification is complete.

COMMERCIAL AND OTHER LARGE VEHICLE RESTRICTIONS: Due to the shoulder widths, large commercial trucks and other large vehicles will be required to stay on the mainline.

TOLL PLAZA INFO – Toll plazas will be utilized per the plan.

The positioning of FHP or other Law Enforcement and the EAV are identified in the typical layout plan sheet as shown in the Concept Plans.

DURATION

MONITORING OPERATIONS: During this operation FDOT D5 EOC, FTE, CFX, FHP, and other law enforcement units will continually monitor the traffic flow. Any bottlenecks or traffic difficulties will be promptly and appropriately dealt with. Interchange areas will be monitored, and ramps will be closed by FHP and/or other law enforcement agencies when deemed necessary.

EMERGENCY RESPONSE: Emergency response vehicles will utilize the inside paved shoulders and crossovers to respond to emergency situations. Crossovers are listed on sheets five (5) of the concept plan. If necessary, air-evacuations may be utilized for injuries and medical emergencies.

CRASH CLEARANCE: Crashes will be cleared off the roadway as expeditiously as possible. If the vehicle can be driven or able to be pushed, it will be moved off the roadway as far as possible. Wreckers will be called from the wrecker rotation list or by the ERAS Contractor and will use the available shoulders and median strip to respond to the crash scene.

RAMP/LANE CLOSURES: There are no planned ramp closures currently. If an incident occurs requiring ramp or lane closures, law enforcement will request FDOT resources for maintenance of traffic (MOT) support via the RTMC. A Road Ranger will provide initial support until the Asset Contractor can respond. Per the Road Ranger contract, they should not be on scene for more than an hour. The Asset Contractor will respond as soon as possible with the appropriate MOT to meet the needs of the incident as defined in their established contractual requirements.

POST IMPLEMENTATION OPERATIONS

The following will take place upon the determination to end ESU Operations. Time required to remove the ESU devices from the time the decision is made to cease ESU = 4 hours.

Post Implementation Operations	Responsible Party	Location	Timeline (How Long)	Quality Control
Demobilization of Motorist Assistance Contractors	FDOT / FTE / RTMC	Entire Corridor Length	On-Going during Post-Implementation	FDOT / FTE / RTMC
Monitor ITS for Any Changes	FDOT / RTMC	Entire Corridor Length	On-Going during Post-Implementation	DME / RTMC
Coordinate with Local Agency Partners	FDOT D5 EOC	Entire Corridor Length	On-Going during Post-Implementation	DME
Coordinate with social media, local news partners	FDOT / FTE / CFX PIO Offices	Entire Corridor Length	On-Going during Post-Implementation	DME
Coordinate with Decision Makers	FDOT / FTE / CFX	Entire Corridor Length	On-Going	DME

THE OPERATION WILL TERMINATE PRIOR TO TROPICAL STORM FORCE WINDS TO ALLOW FOR TRAFFIC ON THE ROADWAY TO CLEAR AND FOR PERSONNEL TO SEEK SHELTER.

WHEN TO TERMINATE OPERATION: The traffic volume and speeds will determine the duration of the ESU Operations. When it is apparent that traffic in the westbound lanes is flowing smoothly and the volume is not as great as to create bottlenecks, the FDOT in coordination with the SEOC, FHP, TPE, and RTMC will assess the information and determine when to terminate ESU operations

The FHP Troop D will be notified via their chain of command that the Department is ready to cease operation of the SR 528 ESU.

PUBLIC INFORMATION: Prior to the termination of the ESU, the Communications Office will notify the media that the operation is going to be terminated and give them the time of termination.

POST EVENT OPERATIONS

Post Event Operations	Responsible Party	Location	Timeline (How Long)	Quality Control
Retrieve Temporary Signs	FDOT LMU / FTE	Per Plans and SOP Equipment List	4 hours	FDOT LMU / FTE
Remove Portable Changeable Message Signs	FDOT LMU / FTE	Per Plans & SOP Equipment List	2 - 3 hours	FDOT LMU / FTE
Ride the Corridor	FDOT / FTE / CFX	Entire Corridor Length	4 hours	FDOT LMU / FTE

RECOVER AND STORE EQUIPMENT: All deployed resources will be recovered or restored by the FDOT LMU & FTE.

ATTACHMENT A: LIST OF ACRONYMS

- AC Area Command (District Five Maintenance Engineer)
- AMC Asset Management Contractor
- CDC Center for Disease Control
- D5 FDOT District 5
- DECO District Emergency Coordination Officer
- DM District Maintenance
- DME District Manager Engineer
- DMS Dynamic Message Signs
- EAV Emergency Assistance Vehicle
- EOC Emergency Operations Center
- ERAS Emergency Roadside Assistance Service
- ESU Emergency Shoulder Use
- FDOT Florida Department of Transportation
- FHP Florida Highway Patrol
- ICS Incident Command System
- ITS Intelligent Traffic System
- LEO Law Enforcement Officer
- LMU Local Maintenance Unit
- MOT Maintenance of Traffic
- MRP Maintenance Rating Program
- NIMS National Incident Management System
- PCMS Portable Changeable Message Signs
- PPE Personal Protective Equipment
- RISC Rapid Incident Scene Clearance
- RTMC Regional Transportation Management Center
- SEOC State Emergency Operations Center
- SLERS State Law Enforcement Radio System
- SOP Standard Operating Procedure
- TMC Traffic Management Center
- FTE Florida's Turnpike Enterprise

ATTACHMENT B: SIGN TABLE

Road	County	Mile Marker	Placement Note	Message
Temporary Signs, PCMS, and Traffic Control Devices to be placed per Concept Plan Sheets 7-18				

ATTACHMENT C: SIGN AND LOCATION EXAMPLE

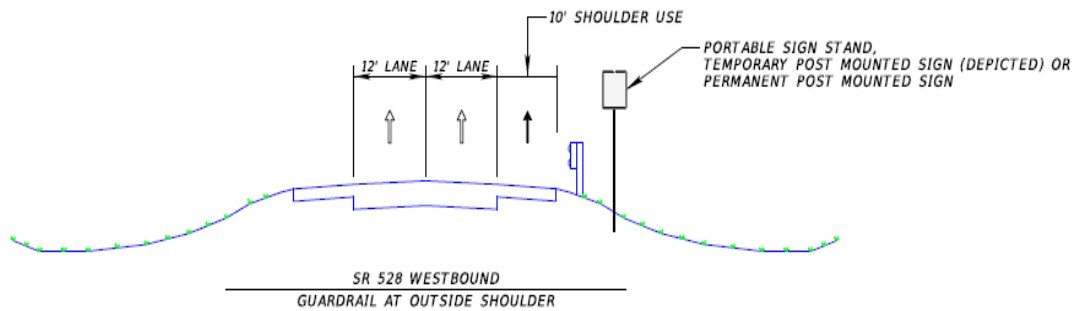
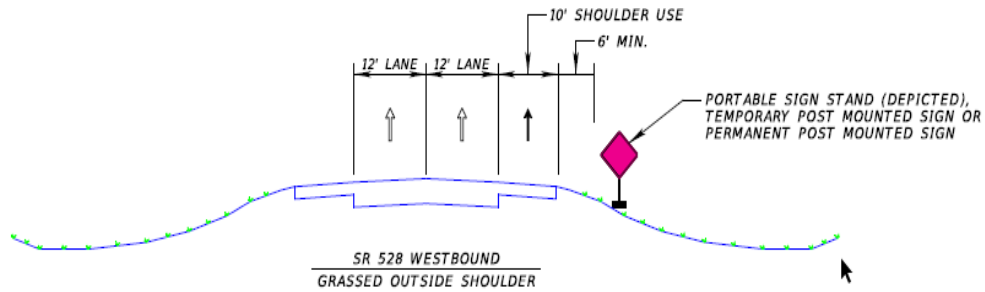

- LEGEND**
- EMERGENCY SHOULDER USE (ESU) LANE
 - ⇒ GENERAL USE LANE

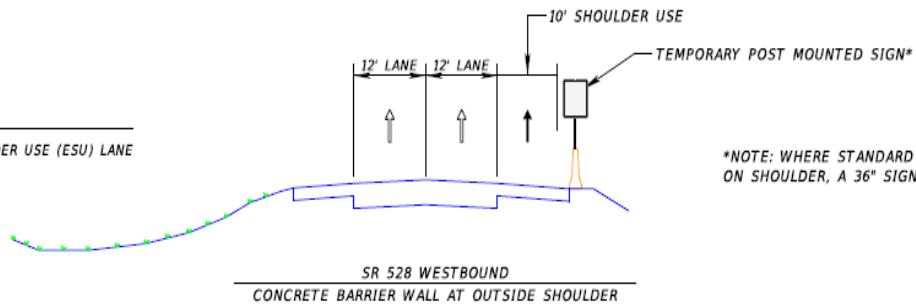

*NOTE: WHERE STANDARD SIGN WILL ENCROACH ON SHOULDER, A 36" SIGN SHOULD BE USED.

ATTACHMENT D: PRECAUTIONS FOR SAFETY SERVICE PATROLS (during Pandemic)

General Guidance

- Practice proper hand hygiene by promptly washing your hands or using hand sanitizer after physically interacting with others.
- If washing your hands, please do so for at least 20 seconds with soap and warm water.
- Avoid touching your face (eyes, nose, and mouth).
- Cover your mouth and nose with your bent elbow or tissue when you cough or sneeze. Make sure to dispose of the tissue immediately.
- Avoid close physical contact with others, including shaking hands and hugging.
- Maintain at least six (6) feet distance between yourself and anyone who is coughing or sneezing, when possible.
- Promptly disinfect your gear after physical contact with any individual.
- Keep an adequate supply of disinfectant wipes and hand sanitizer in an easily accessible place while on-duty.
- Wear a mask when assisting motorists and properly dispose after use.
- Educate yourself and participate in training on the use of Personal Protective Equipment (PPE) for respiratory protection, if available.
- Ensure only trained personnel wearing appropriate PPE have contact with individuals who have or may have PANDEMIC DISEASE.
- Seek medical care if you have a fever, cough or difficulty breathing.

Interaction with Motorists

- Wear masks as recommended by Centers for Disease Control (CDC) guidance, during all interactions during a shift to limit the amount of exposure with motorists.
- Approach motorists only from the passenger side window unless an alternate approach is necessary to maintain safety.
- Insist motorists stay in their vehicles.
- Instead of allowing a motorist to use the cell phone, make the call for them or allow the motorist to speak via speaker phone while maintaining a safe distance of at least 6 feet.

Transporting Motorists

- Call EMS/EMTs if the motorist has any medical emergency. Symptomatic and Asymptomatic PANDEMIC DISEASE is in itself not a medical emergency.
- Do not transport motorists except in emergency cases.
- Should you need to provide transport, wear a mask at all times and do not use recirculating (max) air conditioning until the passenger has exited the vehicle and a full wipe-down has been completed.
- Where the motorist vehicle is in a safe position, have drivers and passengers wait in vehicles for rides, particularly in inclement weather.
- Provide a protective block and traffic control while motorists wait for a ride.

Equipment/Cleaning

- Always use PPE if available.
- Conduct intensive vehicle cleanings before, during and after every shift.
- Wear masks as recommended by CDC guidance and ensure proper training for wearing masks.
- Clean State Law Enforcement Radio System (SLERS) communications equipment in accordance with Technical Services Memorandum(s) 42-05B & 42-07A.
- Each Road Ranger should have cleaning materials and hand sanitizer with them at all times.
- Sanitize any equipment that's frequently touched.
- Crack windows during downtime to air vehicles.
- Use fresh air circulation instead of recirculating A/C setting.
- Use FDOT procedures on how best to clean/disinfect SLERS radios.

Shift Practices

- Some patrol shifts have decreased or modified due to staffing or traffic demands.
- Some dispatch employees may work remotely.
- Patrol drivers may hold meetings over the phone or radio rather than in person.
- The requirement to disseminate brochures, Move It cards, etc. have been suspended until further notice.

Work-Home Practices

- Change out of uniform at the end of a shift immediately after returning home prior to interacting with family members.
- Practice good hygiene upon entering the home to include washing hands, changing clothes, etc.
- Keep field uniform and shoes away at an isolated space before entering in the main living space.