

STATE OF FLORIDA  
DEPARTMENT OF TRANSPORTATION

***I-4 EASTBOUND - TAMPA TO ORLANDO  
EMERGENCY SHOULDER USE (ESU) CONCEPT PLANS  
2022 (LEFT SHOULDER USE ONLY)***

STATE ROAD NO. 400 (I-4)

**INDEX OF SHOULDER USE CONCEPT PLANS**

SHEET NO.	SHEET DESCRIPTION
1	KEY SHEET
2	GENERAL NOTES AND SUMMARY OF QUANTITIES
3-4	FEATURE TABULATION
5	TYPICAL SIGN PLACEMENT
6-7	PROJECT LAYOUT
8-10	PLAN SHEETS
11-15	SIGN DETAILS

HILLSBOROUGH COUNTY	(10190000)
POLK COUNTY	(16320000)
OSCEOLA COUNTY	(92130000)

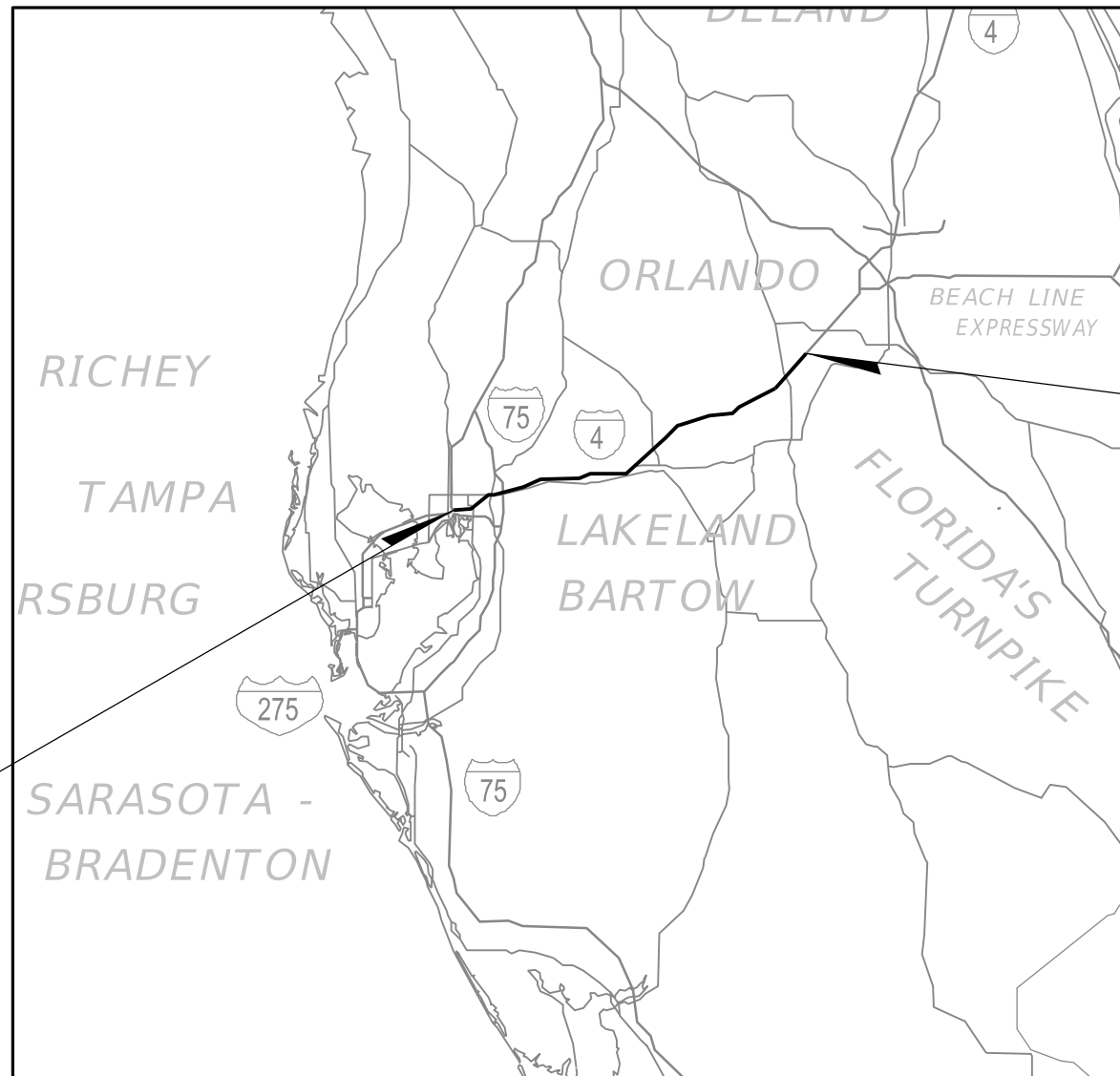
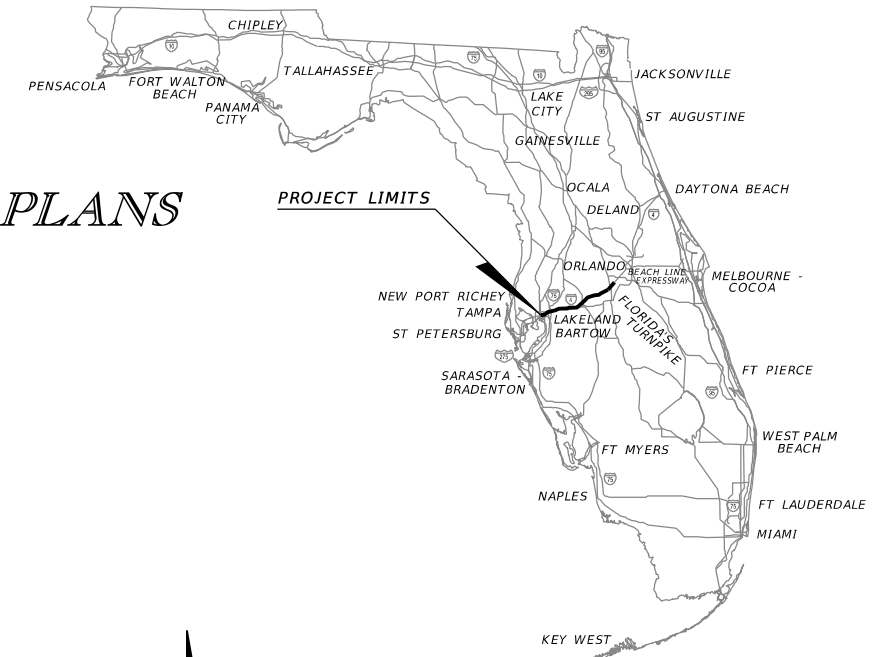

BEGIN EB PROJECT  
HILLSBOROUGH COUNTY  
MM 3

END EB PROJECT  
OSCEOLA COUNTY  
MM 63







04/27/2022

FISCAL YEAR	SHEET NO.
22	1

**GENERAL NOTES**

1. THE PAVED SHOULDER WIDTH ALONG THIS CORRIDOR HAS BEEN FIELD VERIFIED TO BE AT LEAST 10'-0" MEASURED FROM THE EDGE OF THE PAVED SHOULDER OR FACE OF GUARDRAIL OR CONCRETE BARRIER WALL TO THE EDGE OF THE STRIPE. HOWEVER, IF CONSTRUCTION WORK OR OTHER CONDITION RESULTS IN A PAVED SHOULDER WIDTH, AT THE TIME OF IMPLEMENTATION, LESS THAN 10'-0" BUT AT LEAST 9'-0". SEE NARROW SHOULDER LAYOUT SHEET.
2. IMPLEMENTATION OF SHOULDER USE MAY BE ALONG THE ENTIRE CORRIDOR OR ALONG SPECIFIC SECTIONS OF THE CORRIDOR.
3. DEBRIS, ENCROACHING VEGETATION AND HAZARDS ON BOTH SHOULDERS SHALL BE REMOVED PRIOR TO IMPLEMENTATION OF SHOULDER USE.
4. SIGNS MAY BE PERMANENT, TEMPORARY, OR PORTABLE INSTALLATIONS. IF PERMANENT OR TEMPORARY INSTALLATIONS ARE USED, THE SIGNS SHALL BE BLACK LEGEND ON WHITE BACKGROUND FOR REGULATORY SIGNS AND BLACK LEGEND ON YELLOW BACKGROUND FOR WARNING SIGNS. IF PORTABLE INSTALLATIONS ARE USED, THE SIGNS SHALL BE BLACK LEGEND ON FLUORESCENT PINK BACKGROUND. THE SIGN MESSAGES SHALL ONLY BE DISPLAYED UPON IMPLEMENTATION.
5. DISTRICT SPECIFIC STANDARD OPERATING PROCEDURE (SOP) WILL BE DEVELOPED AND PROVIDED BY EACH FDOT DISTRICT. THESE WILL ADDRESS REQUIREMENTS AND STANDARD PROCEDURES FOR TEMPORARY AND PERMANENT SIGN INSTALLATIONS, EMERGENCY ASSISTANCE VEHICLE, LAW ENFORCEMENT OFFICER AND OTHER PERTINENT INFORMATION REGARDING THE IMPLEMENTATION OF SHOULDER USE FOR EMERGENCY EVACUATION PURPOSES.
6. UNLESS OTHER TRAFFIC INCIDENT MANAGEMENT MESSAGES TAKE PRECEDENCE, THE DEFAULT MESSAGE ON THE PERMANENT DMS SHALL BE SINGLE- PHASE, THREE -LINE MESSAGE:  
  
**LEFT SHOULDER OPEN FOR USE - NO TRUCKS BUSES OR TRAILERS**  
  
IF REQUIRED, USE OF ABBREVIATED TEXT IS ALLOWED PER MANUAL ON UNIFORM TRAFFIC CONTROL DEVICES (MUTCD) SECTION 1A.
7. DMS - DYNAMIC MESSAGE SIGN  
PCMS - PORTABLE CHANGEABLE MESSAGE SIGN  
EAV - EMERGENCY ASSISTANCE VEHICLE  
LEO - LAW ENFORCEMENT OFFICER
8. CHANNELIZING DEVICES MAY BE TRAFFIC CONES, PLASTIC DRUMS OR TUBULAR MARKERS.
9. SIGNS AND TEMPORARY MOUNTS SHALL BE ON THE APPROVED PRODUCTS LIST (APL).
10. ESU SHOULD ONLY BE IMPLEMENTED IN DRY CONDITIONS. IF RAIN OR FOG EXISTS, ESU SHOULD BE TERMINATED UNTIL FURTHER GUIDANCE IS PROVIDED BY THE STATE TRAFFIC ENGINEERING AND OPERATIONS OFFICE.

**LEGEND**

-  EMERGENCY ASSISTANCE VEHICLE (SHOWN FOR INFORMATION ONLY)
-  LAW ENFORCEMENT OFFICER (LEO) (FIXED POSITIONS)
-  PORTABLE CHANGEABLE MESSAGE SIGN (PCMS)
-  TEMPORARY STATIC SIGN
-  CHANNELIZING DEVICE

**TABULATION OF QUANTITIES**

LOCATIONS	NUMBER	LAW ENFORCEMENT OFFICER (LEO)	EMERGENCY ASSISTANCE VEHICLE (EAV)	PORTABLE CHANGEABLE MESSAGE SIGN (PCMS)	TEMP. STATIC SIGN	CHANNELIZING DEVICES
BEGIN	1	1	1	2	1	0
END	1	1	1	1	5	0
INTERCHANGE	24	0	0	0	48	0
REST AREA/ WEIGH STATION	2	0	0	0	0	0
NARROW SHOULDER	11	0	0	0	33	0
TOTAL		2	2	3	84	0

**NOTES:**

1. LAW ENFORCEMENT OFFICER (LEO) LOCATIONS SHOWN ON THE PLANS ARE FIXED LOCATIONS AND DO NOT ACCOUNT FOR ADDITIONAL SUPPORT ACTIVITIES OR PATROLLING ACTIVITIES.
2. EMERGENCY ASSISTANCE VEHICLE (EAV) LOCATIONS SHOWN ON THE PLANS DO NOT ACCOUNT FOR ADDITIONAL SUPPORT ACTIVITIES.

**SHEET LAYOUT**

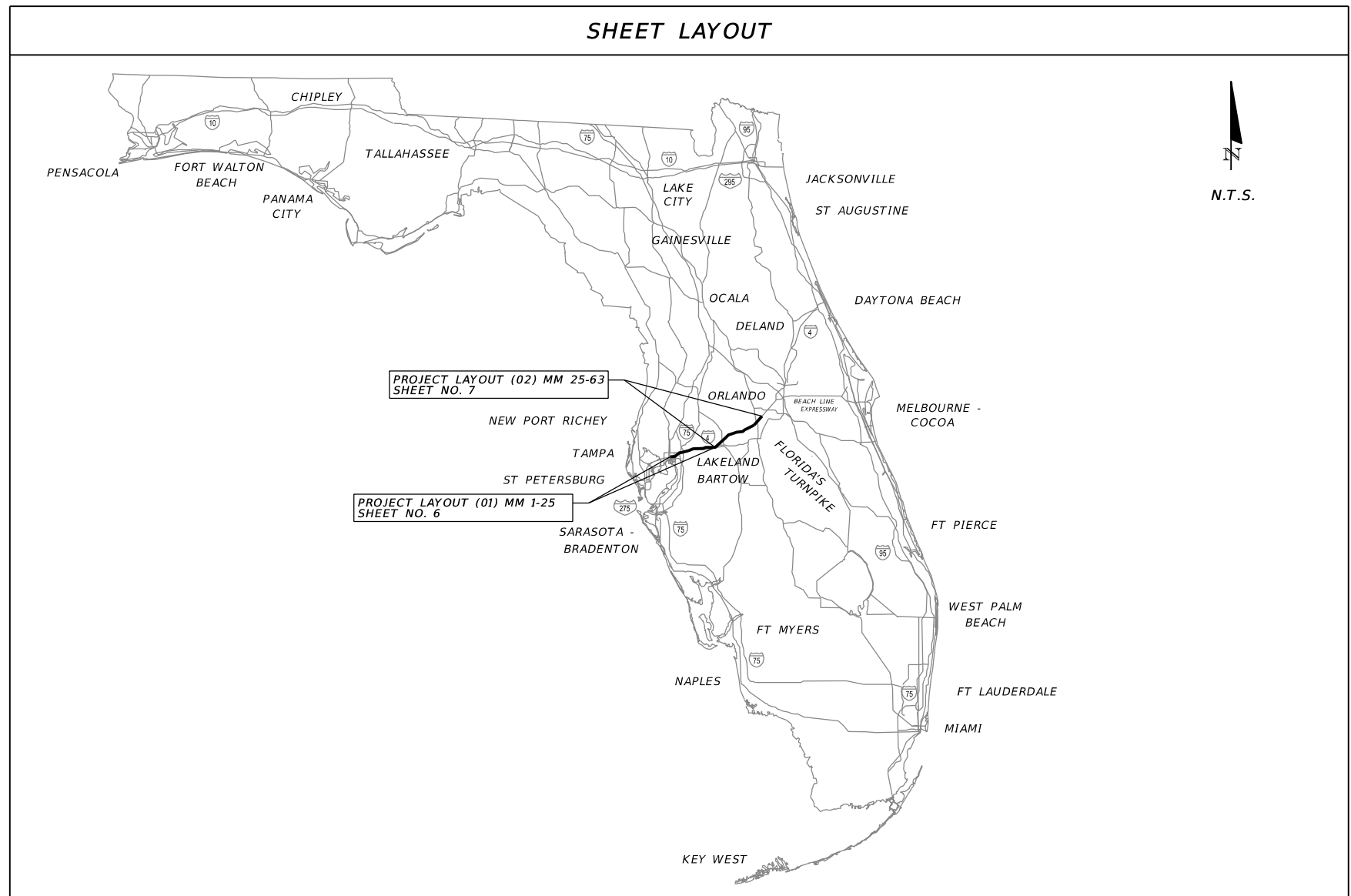

REVISIONS				STATE OF FLORIDA DEPARTMENT OF TRANSPORTATION			GENERAL NOTES AND SUMMARY OF QUANTITIES	SHEET NO.  2
DATE	DESCRIPTION	DATE	DESCRIPTION	ROAD NO.	COUNTY	FINANCIAL PROJECT ID		
				SR 400 (EB)	ALL COUNTIES IN PROJECT LIMITS			

CONSTRUCTION PROJECTS										
FPID	DISTRICT	COUNTY	DESCRIPTION	MM BEGIN	MM END	START DATE	END DATE	ESU IMPACT (DURING 2022 HURRICANE SEASON)	ESU IMPACT (OUTSIDE 2022 HURRICANE SEASON)	DESIGN VARIATION
443320-1	7	HILLSBOROUGH	I-4 FROM EAST OF MANGO RD TO W OF WB WEIGHT STATION	11	11.5	MAY-22	TBD			
445362-2	7	HILLSBOROUGH	I-4/SR 400 FROM DOWNTOWN TAMPA TO POLK COUNTY LINE - CAV	1	25	APR-22	OCT-23			
445362-3	1	POLK	I-4/SR 400 FROM POLK CO LINE TO OSCEOLA CO LINE - CAV	25	58	JUL-22	JAN-24			
201217-8	1	POLK	I-4 AT CSX RAILROAD	29.5	29.5	JAN-21	OCT-23		X	X
431376-1	1	POLK	I-4 FROM SR 33 TO CR 557 (OLD GRADE RD), RESURFACING	38	47	MAY-21	JUL-22		X	
201215-3	1	POLK	I-4 AT SR 557	47	48.8	AUG-20	SEP-23			
446345-1	1	POLK	I-4 FROM SR 557 TO OSCEOLA COUNTY LINE, RESURFACING	47	65	MAY-22	NOV-22			
445362-4	5	OSCEOLA	I-4/SR 400 FROM POLK CO LINE TO DOWNTOWN ORLANDO - CAV	58	83	JUL-22	JAN-24			
444187-1	5	OSCEOLA	I-4 AT CR 532 INTERCHANGE FROM S GOODMAN RD TO KEMP RD	58.5	58.75	JUL-21	SEP-22			
443958-1	5	OSCEOLA	I-4 FROM POLK COUNTY LINE TO W. OF SR 417, RESURFACING	58	62	NOV-21	AUG-23			
444329-1	5	OSCEOLA	I-4 AUX LANES FROM CR 532 TO SR 429	58	60	NOV-21	AUG-23			

\* There is ESU Impact (indicated with an "X") when the shoulder cannot be returned to the existing condition and open an emergency travel lane within 24 hours of being notified of an emergency event. If work within the shoulder can be discontinued and the shoulder can be cleared and opened within 24 hours of being notified of an emergency event, then there is no ESU impact.

LEO LOCATION ASSIGNMENT TABLE (FHP TROOPS)			
NO.	LEO NUMBER	MILE MARKER	LOCATION
1	4EB-3	3	E. OF US 31
2	4EB-63	63	W. OF SR 417

TELEMETER TRAFFIC MONITORING SITE (TTMS)						
NO.	DISTRICT	COUNTY	LOCATION	MILE MARKER	LIVE POLL	SHOULDER LOOP
1	7	HILLSBOROUGH	UNDER BETHLEHAM RD OVERPASS	16.5	DAILY	YES
2	1	POLK	0.6 MI W OF SR-559	43.4	DAILY	YES

EAV LOCATION ASSIGNMENT TABLE			
NO.	EAV NUMBER	MILE MARKER	LOCATION
1	4EB-3	3	E. OF US 31
2	4EB-63	63	W. OF SR 417

REVISIONS				STATE OF FLORIDA DEPARTMENT OF TRANSPORTATION			FEATURE TABULATION (01)	SHEET NO.
DATE	DESCRIPTION	DATE	DESCRIPTION	ROAD NO.	COUNTY	FINANCIAL PROJECT ID		
				SR 400 (EB)	ALL COUNTIES IN PROJECT LIMITS			3

NARROW SHOULDER LOCATIONS					
COUNTY	DISTRICT	MILE POST	MILE MARKER	WIDTHS	RECOMMENDATIONS
HILLSBOROUGH	7	11.978	4.9	9' - 0"	SEE NARROW SHOULDER LAYOUT SHEET
HILLSBOROUGH	7	12.237	5	9' - 7"	SEE NARROW SHOULDER LAYOUT SHEET
HILLSBOROUGH	7	12.849	6.1	9' - 6"	SEE NARROW SHOULDER LAYOUT SHEET
HILLSBOROUGH	7	12.869	6.2	9' - 7"	SEE NARROW SHOULDER LAYOUT SHEET
HILLSBOROUGH	7	13.43	6.7	9' - 0"	SEE NARROW SHOULDER LAYOUT SHEET
HILLSBOROUGH	7	13.741	7.2	9' - 0"	SEE NARROW SHOULDER LAYOUT SHEET
HILLSBOROUGH	7	19.163	11.4	9' - 6"	SEE NARROW SHOULDER LAYOUT SHEET
HILLSBOROUGH	7	21.15	13.8	9' - 6"	SEE NARROW SHOULDER LAYOUT SHEET
HILLSBOROUGH	7	24.717	16.9	9' - 6"	SEE NARROW SHOULDER LAYOUT SHEET
POLK	1	7.876	33.4	9' - 0"	SEE NARROW SHOULDER LAYOUT SHEET
OSCEOLA	5	3.487	61.1	9' - 4"	SEE NARROW SHOULDER LAYOUT SHEET

SUMMARY OF EMERGENCY CROSSOVERS			
COUNTY	DISTRICT	MILE POST	MILE MARKER
HILLSBOROUGH	7	19.828	12
HILLSBOROUGH	7	23.374	16
HILLSBOROUGH	7	31.204	24
POLK	1	9.925	35
POLK	1	13.575	39
POLK	1	24.743	50
OSCEOLA	5	1.586	59
OSCEOLA	5	3.980	62

DYNAMIC MESSAGE SIGN (DMS)				
NO.	DISTRICT	COUNTY	LOCATION	MILE MARKER
1	7	HILLSBOROUGH	DMS I-4 1.1-M-A	1.1
2	7	HILLSBOROUGH	DMS I-4 1.6-M-A	1.6
3	7	HILLSBOROUGH	DMS I-4 04.0-EB-A	4.0
4	7	HILLSBOROUGH	DMS I-4 07.9-EB-A	7.9
5	7	HILLSBOROUGH	DMS I-4 09.4-EB-A	9.4
6	7	HILLSBOROUGH	DMS I-4 11.6 EB A	11.6
7	7	HILLSBOROUGH	DMS I-4 17.9-EB-A	17.9
8	7	HILLSBOROUGH	DMS I-4 21.4-EB-A	21.4
9	7	HILLSBOROUGH	DMS I-4 24.5-EB-A	24.5
10	7	HILLSBOROUGH	DMS I-4 25.5-EB-A	25.5
11	1	POLK	DMS I-4 29.8-EB-A	29.8
12	1	POLK	DMS I-4 33.1-EB-A	33.1
13	1	POLK	DMS I-4 40.3-EB-A	40.3
14	1	POLK	DMS I-4 42.0-EB-A	42.0
15	1	POLK	DMS I-4 48.7-EB-A	48.7
16	1	POLK	DMS I-4 53.2-EB-A	53.2
17	5	OSCEOLA	I-4 EB @ MM 60.6	60.6
18	5	OSCEOLA	I-4 EB @ MM 63.1	63.1
19	5	OSCEOLA	I-4 EB @ MM 64.3	64.3

REVISIONS				STATE OF FLORIDA DEPARTMENT OF TRANSPORTATION	FEATURE TABULATION (02)	SHEET NO.  4
DATE	DESCRIPTION	DATE	DESCRIPTION			

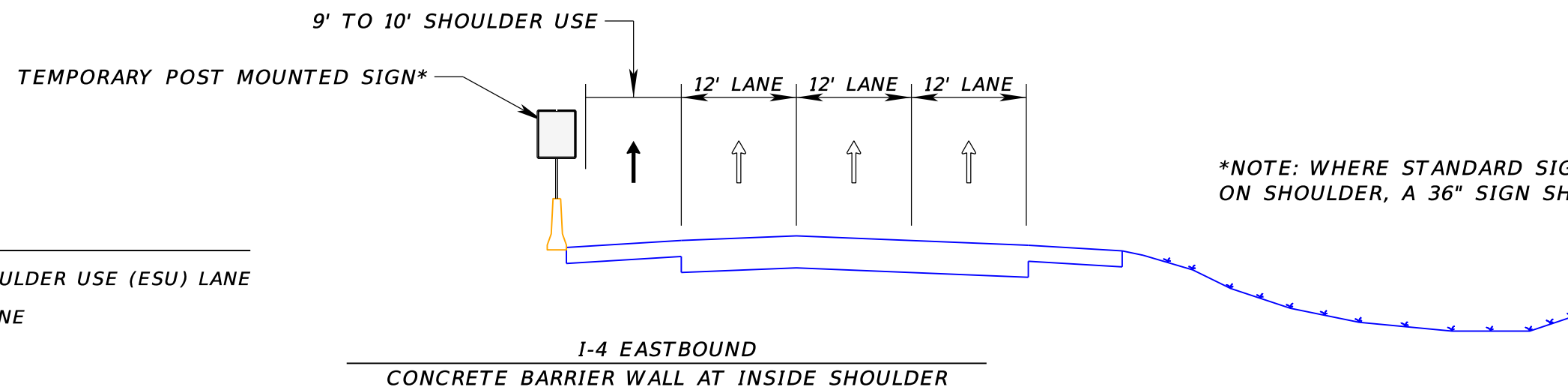
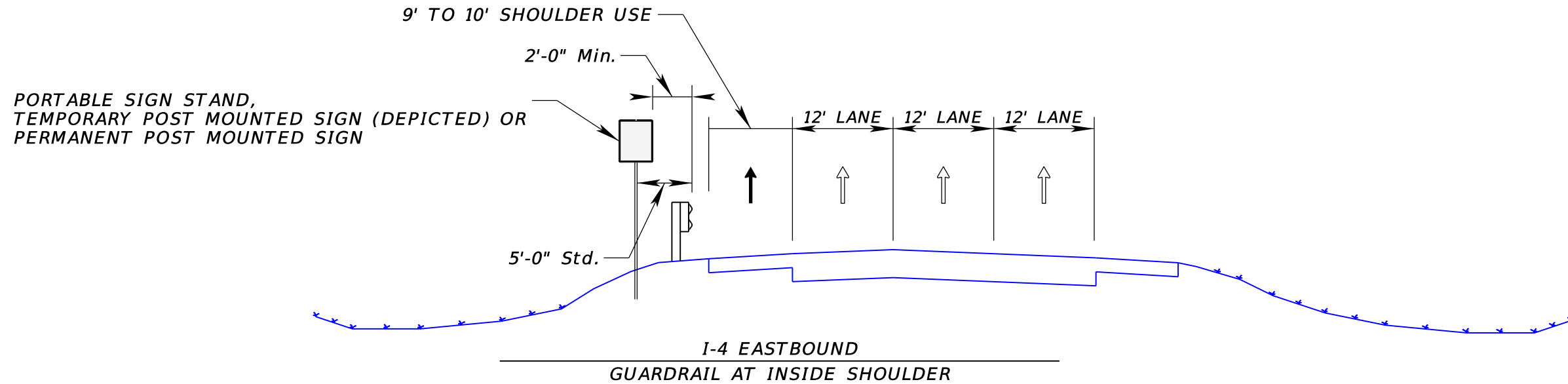
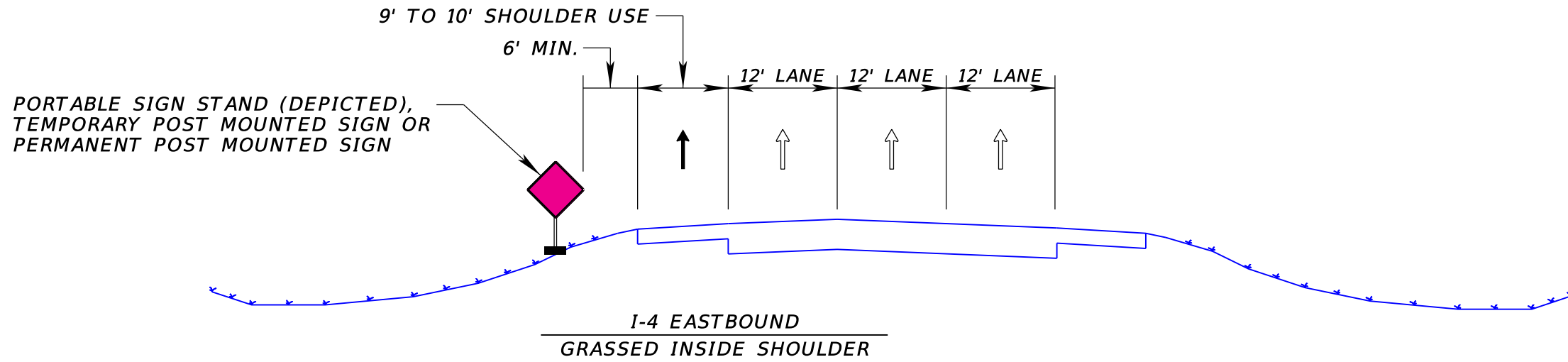

**LEGEND**

→ EMERGENCY SHOULDER USE (ESU) LANE

⇨ GENERAL USE LANE

REVISIONS				STATE OF FLORIDA DEPARTMENT OF TRANSPORTATION			TYPICAL SIGN PLACEMENT	SHEET NO.
DATE	DESCRIPTION	DATE	DESCRIPTION	ROAD NO.	COUNTY	FINANCIAL PROJECT ID		
				SR 400 (EB)	ALL COUNTIES IN PROJECT LIMITS			5

**LEGEND**  
 MM - MILE MARKER  
 → - EMERGENCY SHOULDER USE (ESU) LANE  
 ⇨ - GENERAL USE LANE

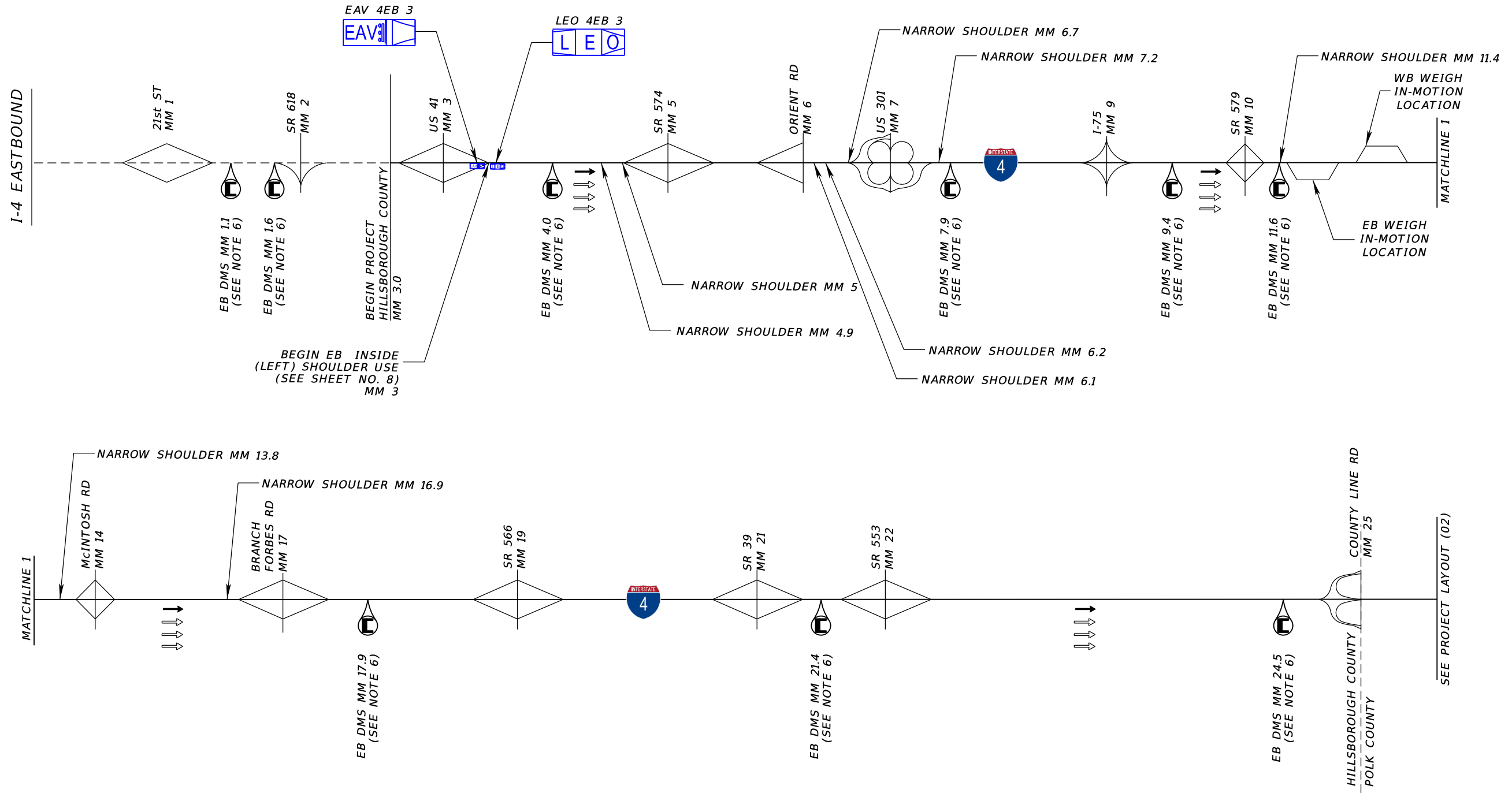

REVISIONS				STATE OF FLORIDA DEPARTMENT OF TRANSPORTATION	PROJECT LAYOUT (01)	SHEET NO. 6
DATE	DESCRIPTION	DATE	DESCRIPTION			

**LEGEND**  
 MM - MILE MARKER  
 - EMERGENCY SHOULDER USE (ESU) LANE  
 - GENERAL USE LANE

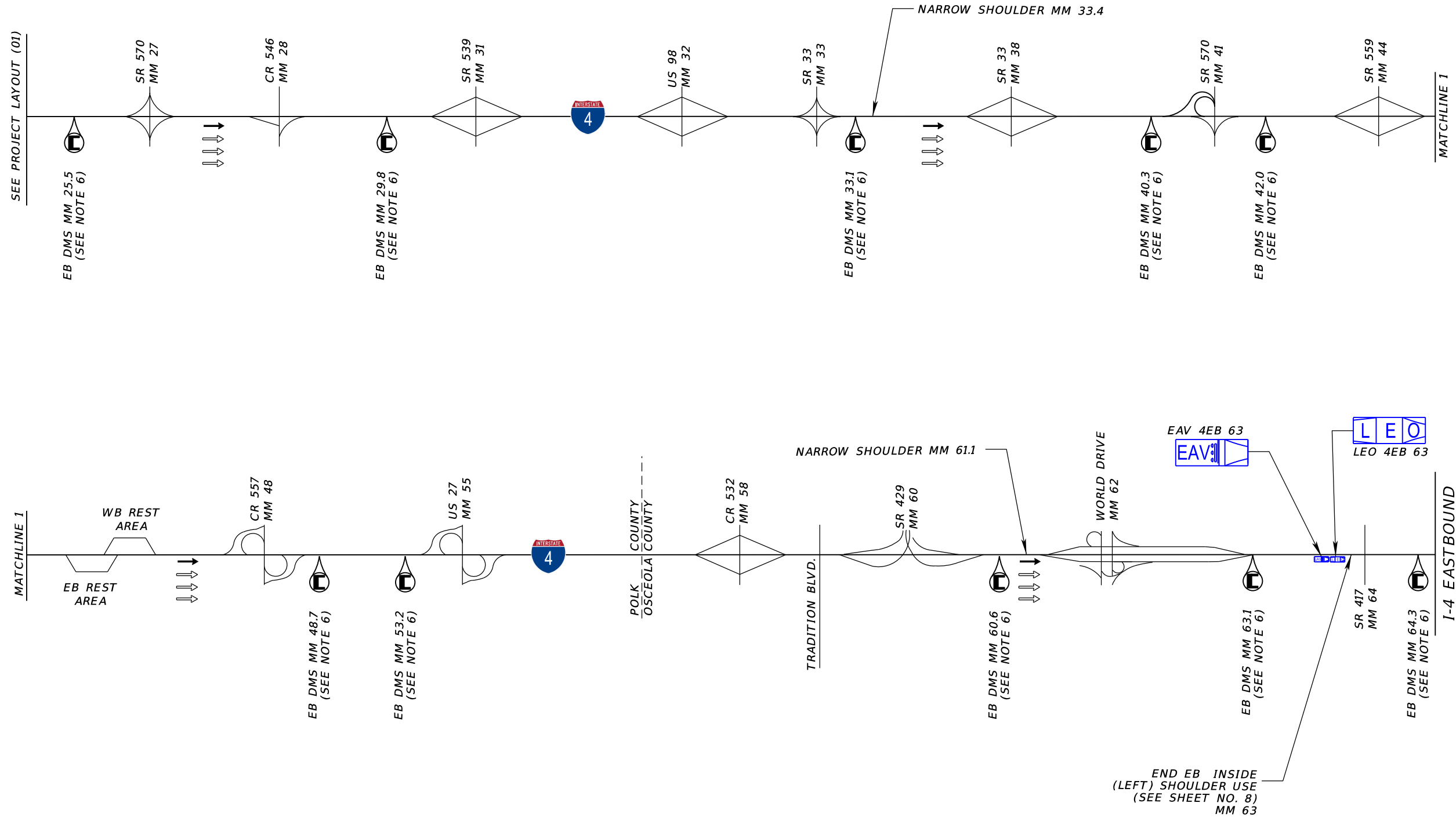

REVISIONS				STATE OF FLORIDA DEPARTMENT OF TRANSPORTATION			PROJECT LAYOUT (02)	SHEET NO.
DATE	DESCRIPTION	DATE	DESCRIPTION	ROAD NO.	COUNTY	FINANCIAL PROJECT ID		
				SR 400 (EB)	ALL COUNTIES IN PROJECT LIMITS			7

PLAN SHEET NOTES:

1. SIGNS SHOULD BE PLACED ONLY ON THE SIDE OF THE SHOULDER BEING USED.
2. BEGIN AND END SHOULDER USE LOCATION MAY BE ADJUSTED DURING FINAL IMPLEMENTATION PLAN FOR THE EVENT.
3. PLACE "SHOULDER CLOSED TO TRAFFIC" SIGN AFTER THE NEXT INTERCHANGE, IF THIS LAYOUT DOES NOT COVER THE LOCATION.

BEGIN SHOULDER USE

END SHOULDER USE

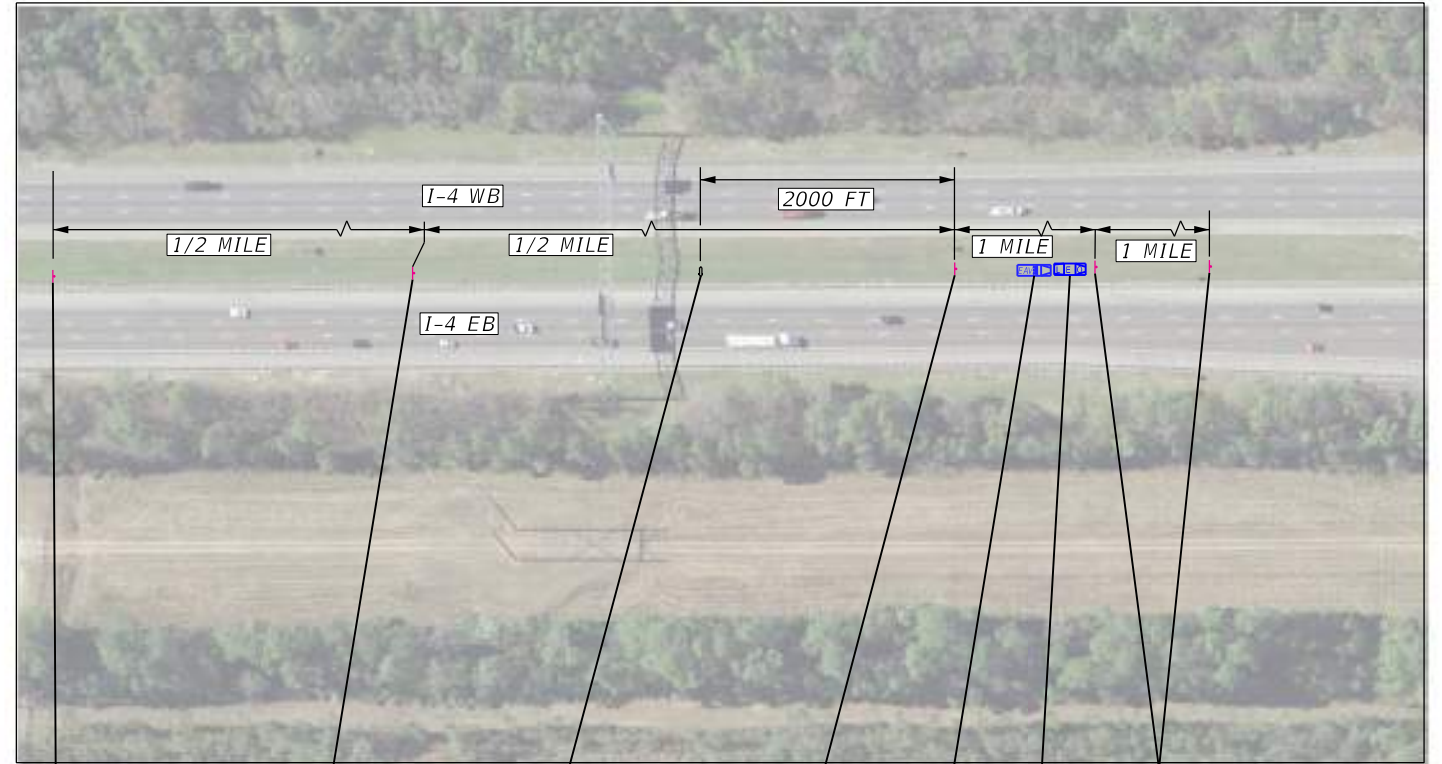

PHASE-1  
**LT SHLDR  
 OPEN  
 1/2 MILE**  
 PHASE-2  
**NO TRUCKS  
 BUSES OR  
 TRAILERS**  
 PCMS

**NO  
 TRUCKS  
 BUSES OR  
 TRAILERS**

EAV

LEO

PHASE-1  
**LT SHLDR  
 OPEN  
 FOR USE**  
 PHASE-2  
**NO TRUCKS  
 BUSES OR  
 TRAILERS**  
 PCMS

**END  
 SHOULDER  
 USE  
 1 MILE**

**END  
 SHOULDER  
 USE  
 1/2 MILE**

**SHOULDER  
 LANE  
 ENDS**  
**MERGE  
 RIGHT  
 2000 FT**  
 PCMS

**END  
 SHOULDER  
 USE**

LEO

EAV

**SHOULDER  
 CLOSED TO  
 TRAFFIC**

REVISIONS				STATE OF FLORIDA DEPARTMENT OF TRANSPORTATION			PLAN SHEETS (01) TYPICAL LAYOUT FOR BEGIN AND END SHOULDER USE	SHEET NO.
DATE	DESCRIPTION	DATE	DESCRIPTION	ROAD NO.	COUNTY	FINANCIAL PROJECT ID		
				SR 400 (EB)	ALL COUNTIES IN PROJECT LIMITS			8



PLAN SHEET NOTE:

- SIGNS SHOULD BE PLACED ONLY ON THE SIDE OF THE SHOULDER BEING USED.

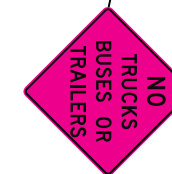

REVISIONS				STATE OF FLORIDA DEPARTMENT OF TRANSPORTATION			PLAN SHEETS (02) TYPICAL LAYOUT AT INTERCHANGES	SHEET NO.
DATE	DESCRIPTION	DATE	DESCRIPTION	ROAD NO.	COUNTY	FINANCIAL PROJECT ID		
				SR 400 (EB)	ALL COUNTIES IN PROJECT LIMITS			9

PLAN SHEET NOTE:

1. SIGNS SHALL BE PLACED ONLY ON THE SIDE OF THE SHOULDER ON WHICH A NARROW SHOULDER IS PRESENT.
2. THIS LAYOUT APPLIES TO ALL NARROW SHOULDER LOCATIONS.

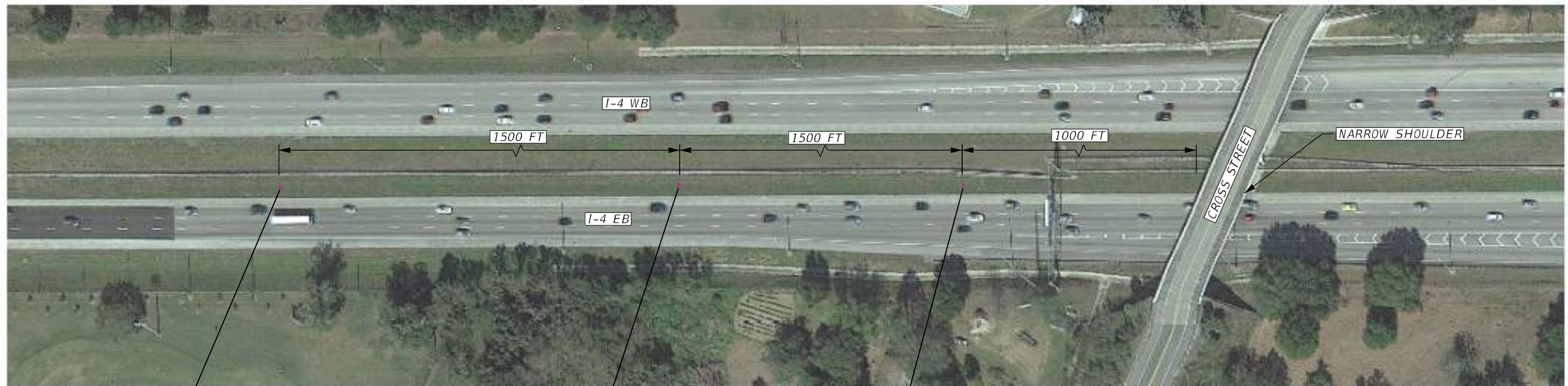

NO  
TRUCKS  
BUSES OR  
TRAILERS

SHOULDER  
NARROWS  
1/2 MILE

SLOW  
DOWN  
SHOULDER  
NARROWS

REVISIONS				STATE OF FLORIDA DEPARTMENT OF TRANSPORTATION	PLAN SHEETS (03) TYPICAL LAYOUT AT NARROW SHOULDERS		SHEET NO.
DATE	DESCRIPTION	DATE	DESCRIPTION				
							ROAD NO.
				SR 400 (EB)	ALL COUNTIES IN PROJECT LIMITS		









