

STATE OF FLORIDA
DEPARTMENT OF TRANSPORTATION

***TRAFFIC INCIDENT
MANAGEMENT PLAN
FOR SR 40***

MARION COUNTY

PLANS PREPARED BY

HNTB

HNTB CORPORATION
300 PRIMERA BLVD., SUITE 200
LAKE MARY, FL 32746
(407) 805-0355
ENGINEERING BUSINESS NO. EB6185

SR 40 DETOUR ROUTE	FIGURE
US 41 TO CR 328	1
US 41 TO INTERSTATE 75	2
INTERSTATE 75 TO US 441 / US 301 / US 27	3
US 441 / US 301 / US 27 TO NE 36TH AVE	4
NE 36TH AVE TO SR 35 (NE 55TH AVE)	5
NE 35TH AVE TO SE HIGHWAY 314 / CR 314	6
SE HIGHWAY 314 / CR 314 TO US 19	7
US 19 TO CR 445A	8

MARION COUNTY
Traffic Incident Management Contact List

Map Pages	Name	Phone	E-mail
	No contact information provided		

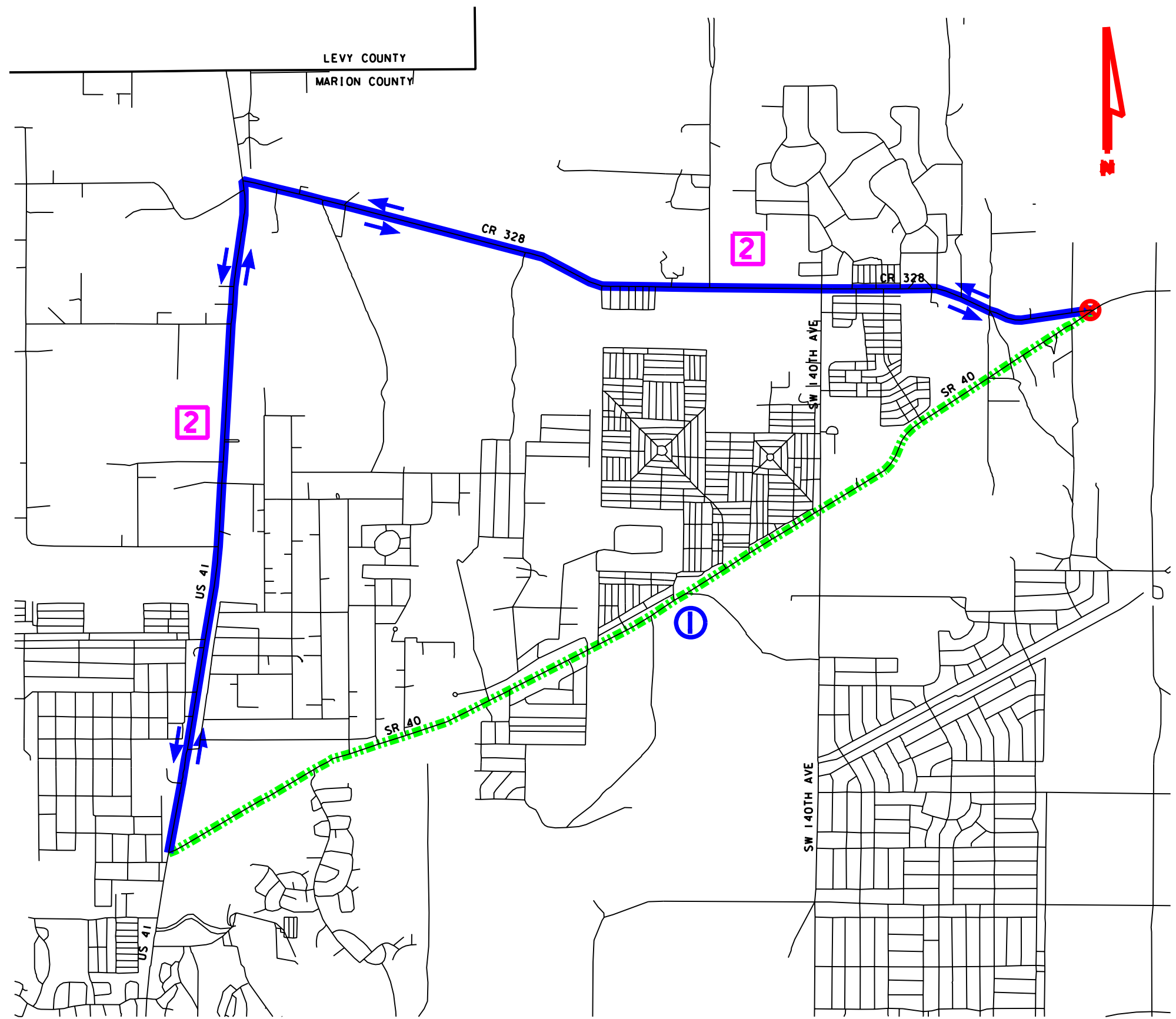

LEGEND

	CLOSED PORTION OF HIGHWAY
	PRIMARY ALTERNATE ROUTES
	SECONDARY ALTERNATE ROUTES
	NUMBER OF LANES
	INCIDENT LOCATION
	DIRECTION OF ROUTED TRAFFIC
	SIGNALIZED INTERSECTION
	EXISTING DETOUR SIGN
	PROPOSED DETOUR SIGN
	PROPOSED VMS SIGN

LIMITS OF CLOSURE:
 US 41 TO CR 328

EB SR 40 PRIMARY REROUTE:
 1) USE NB US 41.
 2) TURN RIGHT ON CR 328.

WB SR 40 PRIMARY REROUTE:
 1) TURN RIGHT ON CR 328.
 2) TURN LEFT ON US 41.

NOTE: LAW ENFORCEMENT TO BE USED AT INTERSECTIONS AS NECESSARY.

REVISIONS		
DATE	BY	DESCRIPTION

ROAD CLOSURE FROM:
US 41 TO CR 328

TRAFFIC INCIDENT MANAGEMENT PLAN	FIGURE
---	------------

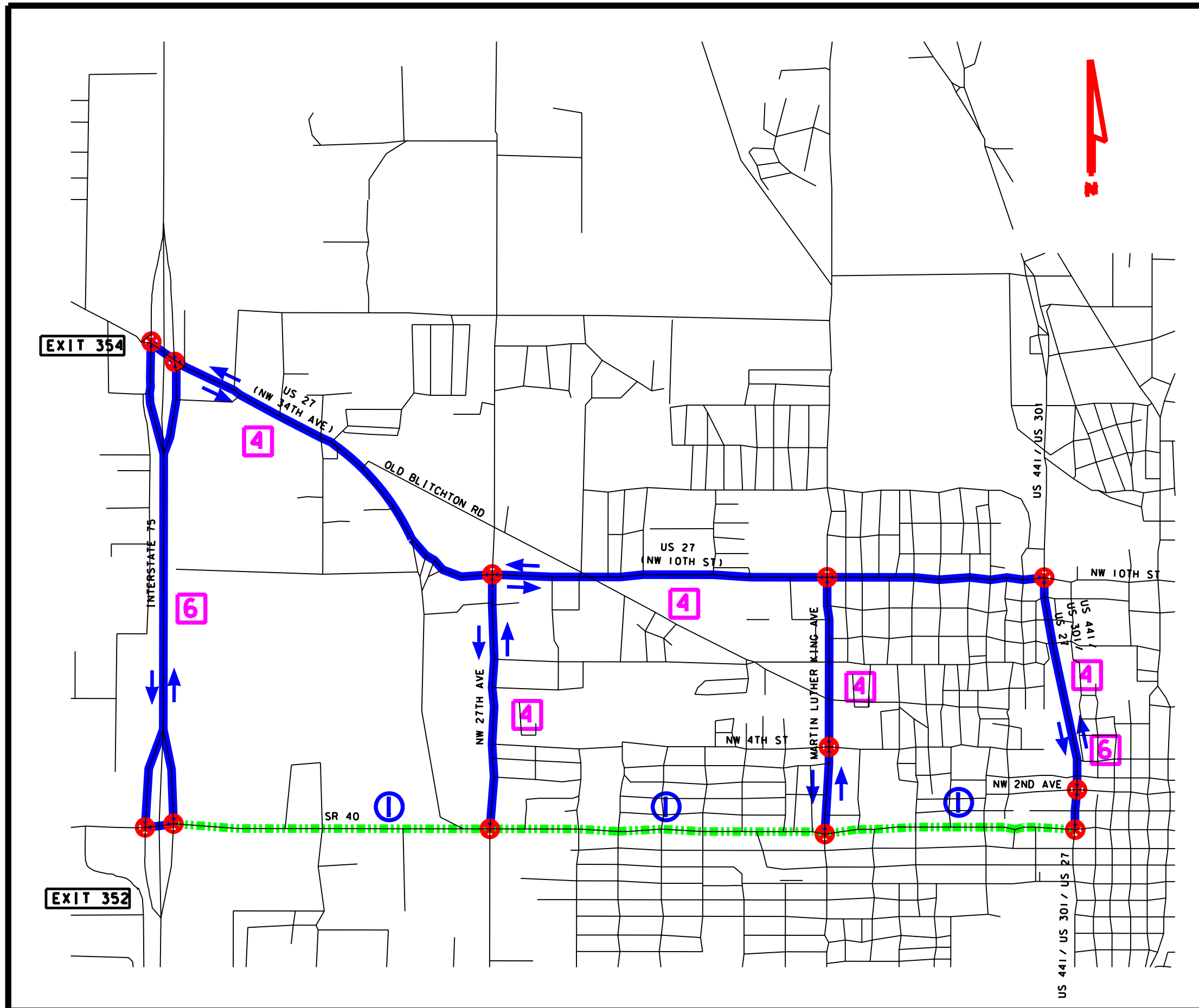

LEGEND

- ▬▬▬▬▬▬ CLOSED PORTION OF HIGHWAY
- ▬▬▬▬▬▬ PRIMARY ALTERNATE ROUTES
- ▬▬▬▬▬▬ SECONDARY ALTERNATE ROUTES
- 4 NUMBER OF LANES
- I INCIDENT LOCATION
- ➔ DIRECTION OF ROUTED TRAFFIC
- ⊗ SIGNALIZED INTERSECTION
- ⊖ EXISTING DETOUR SIGN
- ⊕ PROPOSED DETOUR SIGN
- PROPOSED VMS SIGN

- LIMITS OF CLOSURE:**
 INTERSTATE 75 TO US 441 / US 301 / US 27
- EB SR 40 PRIMARY REROUTE:**
- 1) TURN LEFT ON *
 - 2) TURN RIGHT ON US 27.
 - 3) TURN RIGHT ON *.
- WB SR 40 PRIMARY REROUTE:**
- 1) TURN RIGHT ON *.
 - 2) TURN LEFT ON US 27.
 - 3) TURN LEFT ON *.

* PRIMARY ROUTE DEPENDENT UPON LOCATION OF INCIDENT.

NOTE: LAW ENFORCEMENT TO BE USED AT INTERSECTIONS AS NECESSARY.

REVISIONS		
DATE	BY	DESCRIPTION

ROAD CLOSURE FROM:
**INTERSTATE 75 TO
 US 441 / US 301 / US 27**

TRAFFIC INCIDENT MANAGEMENT PLAN	FIGURE 3
---	--------------------

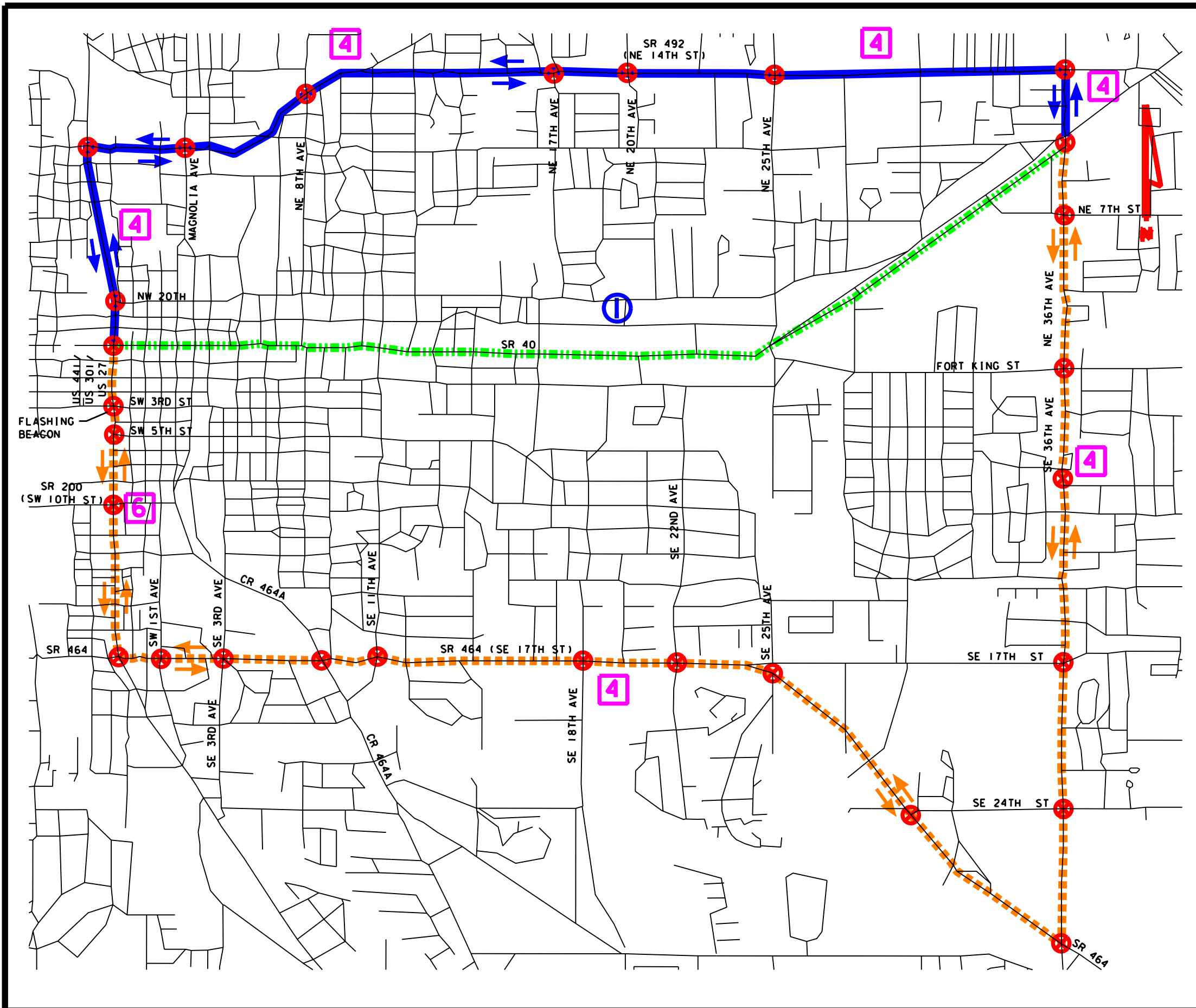

LEGEND

- ▬▬▬▬▬▬ CLOSED PORTION OF HIGHWAY
- ▬▬▬▬▬▬ PRIMARY ALTERNATE ROUTES
- - - - - SECONDARY ALTERNATE ROUTES
- 4 NUMBER OF LANES
- 1 INCIDENT LOCATION
- ➔ DIRECTION OF ROUTED TRAFFIC
- ⊗ SIGNALIZED INTERSECTION
- ⊖ EXISTING DETOUR SIGN
- ⊕ PROPOSED DETOUR SIGN
- PROPOSED VMS SIGN

- LIMITS OF CLOSURE:**
US 441 /US 301 /US 27 TO NE 36TH AVE
- EB SR 40 PRIMARY REROUTE:**
- 1) TURN LEFT ON US 441 /US 301 /US 27.
 - 2) TURN RIGHT ON SR 492 (NE 14TH ST).
 - 3) TURN RIGHT ON NE 36TH ST.
- WB SR 40 PRIMARY REROUTE:**
- 1) TURN RIGHT ON NE 36TH ST.
 - 2) TURN LEFT ON SR 492 (NE 14TH ST).
 - 3) TURN LEFT ON US 441 /US 301 /US 27.
- EB SR 40 SECONDARY REROUTE:**
- 1) TURN RIGHT ON US 441 /US 301 /US 27.
 - 2) TURN LEFT ON SR 464 (SE 17TH ST).
 - 3) TURN LEFT ON SE 36TH AVE.
- WB SR 40 SECONDARY REROUTE:**
- 1) TURN LEFT ON NE 36TH ST.
 - 2) TURN RIGHT ON SR 464 (SE 17TH ST).
 - 3) TURN RIGHT ON US 441 /US 301 /US 27.

NOTE: LAW ENFORCEMENT TO BE USED AT INTERSECTIONS AS NECESSARY.

REVISIONS		
DATE	BY	DESCRIPTION

ROAD CLOSURE FROM:
US 441 /US 301 /US 27 TO
NE 36TH AVE

TRAFFIC INCIDENT MANAGEMENT PLAN	FIGURE 4
---	--------------------

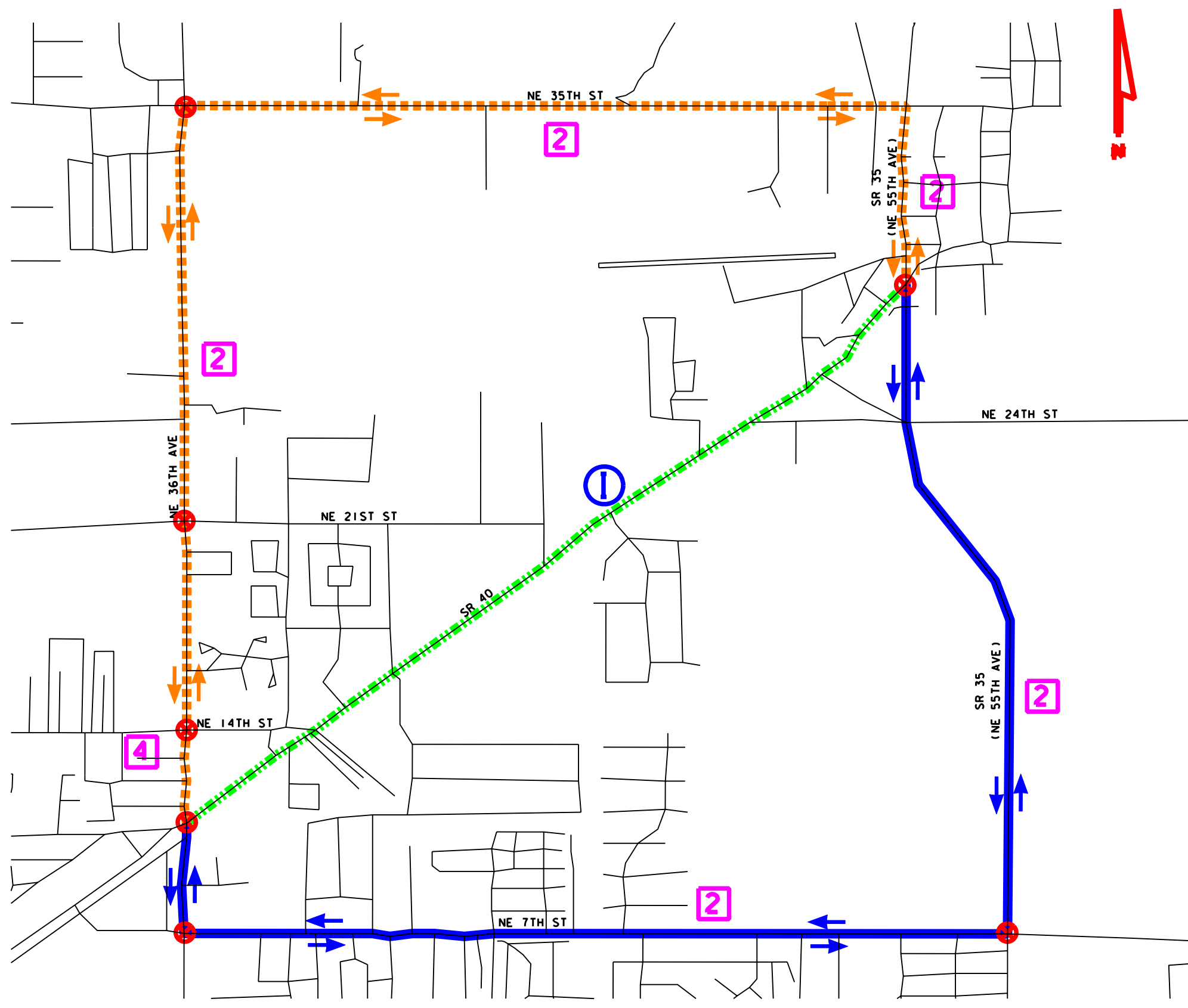

LEGEND

- ▬▬▬▬▬▬ CLOSED PORTION OF HIGHWAY
- ▬▬▬▬▬▬ PRIMARY ALTERNATE ROUTES
- - - - - SECONDARY ALTERNATE ROUTES
- 2 NUMBER OF LANES
- 1 INCIDENT LOCATION
- ➔ DIRECTION OF ROUTED TRAFFIC
- X SIGNALIZED INTERSECTION
- EXISTING DETOUR SIGN
- PROPOSED DETOUR SIGN
- PROPOSED VMS SIGN

- LIMITS OF CLOSURE:**
NE 36TH AVE TO SR 35 (NE 55TH AVE)
- EB SR 40 PRIMARY REROUTE:**
 1) TURN RIGHT ON NE 36TH AVE.
 2) TURN LEFT ON NE 7TH ST.
 3) TURN LEFT ON SR 35 (NE 55TH AVE).
- WB SR 40 PRIMARY REROUTE:**
 1) TURN LEFT ON SR 35 (NE 55TH AVE).
 2) TURN RIGHT ON NE 7TH ST.
 3) TURN RIGHT ON NE 36TH AVE.
- EB SR 40 SECONDARY REROUTE:**
 1) TURN LEFT ON NE 36TH AVE.
 2) TURN RIGHT ON NE 35TH ST.
 3) TURN RIGHT ON SR 35 (NE 55TH AVE).
- WB SR 40 SECONDARY REROUTE:**
 1) TURN RIGHT ON SR 35 (NE 55TH AVE).
 2) TURN LEFT ON NE 35TH ST.
 3) TURN LEFT ON NE 36TH AVE.

NOTE: LAW ENFORCEMENT TO BE USED AT INTERSECTIONS AS NECESSARY.

REVISIONS		
DATE	BY	DESCRIPTION

ROAD CLOSURE FROM:
**NE 36TH AVE TO
 SR 35 (NE 55TH AVE)**

TRAFFIC INCIDENT MANAGEMENT PLAN	FIGURE 5
---	--------------------

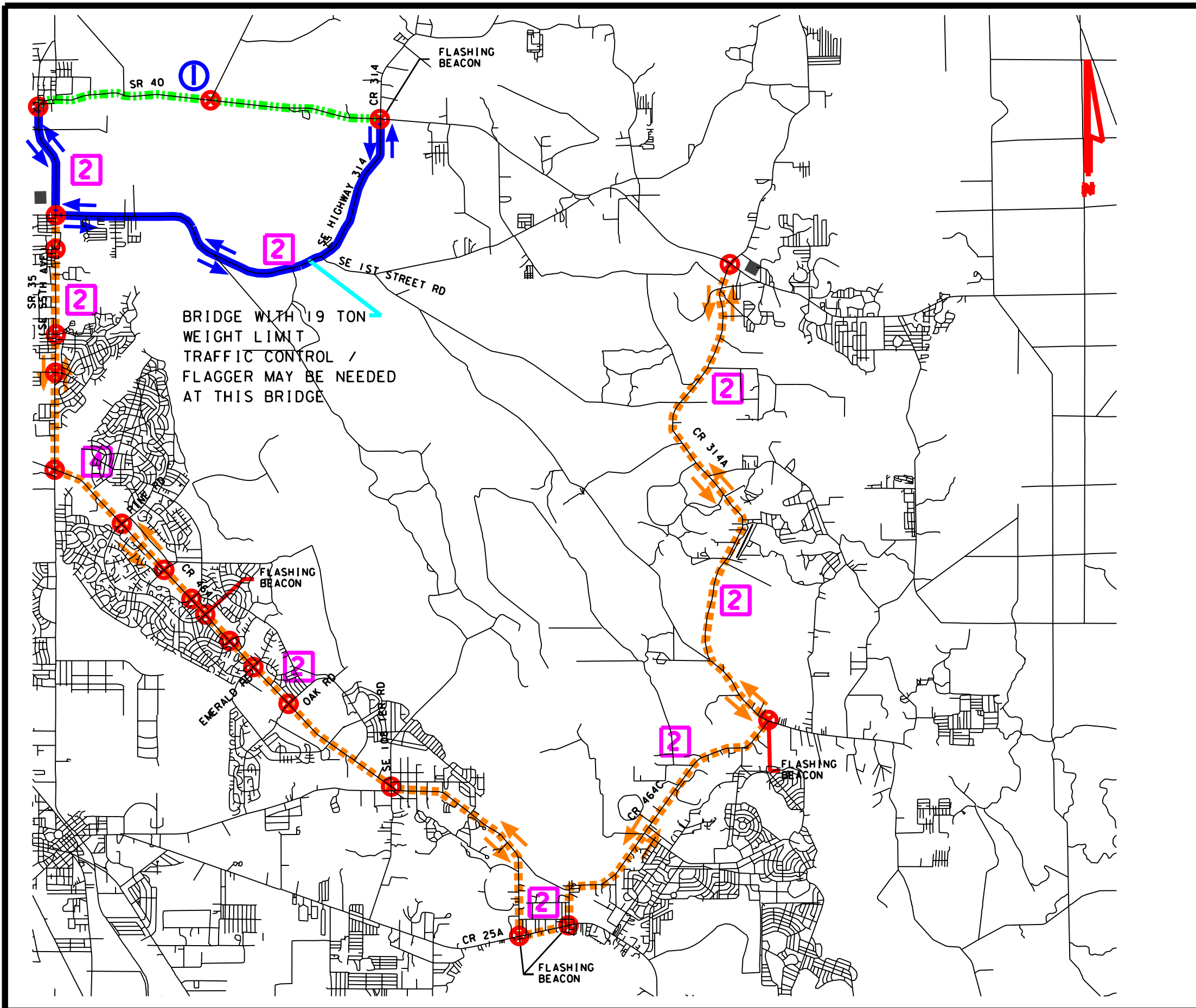

LEGEND

- ▬▬▬▬▬▬ CLOSED PORTION OF HIGHWAY
- ▬▬▬▬▬▬ PRIMARY ALTERNATE ROUTES
- ▬▬▬▬▬▬ SECONDARY ALTERNATE ROUTES
- 2 NUMBER OF LANES
- 1 INCIDENT LOCATION
- ➔ DIRECTION OF ROUTED TRAFFIC
- ⊗ SIGNALIZED INTERSECTION
- ⊙ EXISTING DETOUR SIGN
- ⊙ PROPOSED DETOUR SIGN
- PROPOSED VMS SIGN

- LIMITS OF CLOSURE:**
 SR 35 (NE 55TH AVE) TO SE HIGHWAY 314 / CR 314
- EB SR 40 PRIMARY REROUTE (CARS ONLY):**
 1) TURN RIGHT ON SR 35 (NE 55TH AVE).
 2) TURN LEFT ON SE HIGHWAY 314.
- WB SR 40 PRIMARY REROUTE (CARS ONLY):**
 1) TURN LEFT ON SE HIGHWAY 314.
 2) TURN RIGHT ON SR 35 (NE 55TH AVE).
- EB SR 40 SECONDARY REROUTE (TRUCKS ONLY):**
 1) TURN RIGHT ON SR 35 (NE 55TH AVE).
 2) TURN LEFT ON CR 464.
 3) TURN LEFT ON CR 25A.
 4) TURN LEFT ON CR 464C.
 5) TURN LEFT ON CR 314A.
- WB SR 40 SECONDARY REROUTE (TRUCKS ONLY):**
 1) TURN LEFT ON CR 314A.
 2) TURN RIGHT ON CR 464C.
 3) TURN RIGHT ON CR 25A.
 4) TURN RIGHT ON CR 464.
 5) TURN RIGHT ON CR 35 (NE 55TH AVE).

NOTE: LAW ENFORCEMENT TO BE USED AT INTERSECTIONS AS NECESSARY.

REVISIONS		
DATE	BY	DESCRIPTION

**ROAD CLOSURE FROM:
 SR 35 (NE 55TH AVE) TO
 SE HIGHWAY 314 / CR 314**

TRAFFIC INCIDENT MANAGEMENT PLAN	FIGURE 6
--	------------------------------

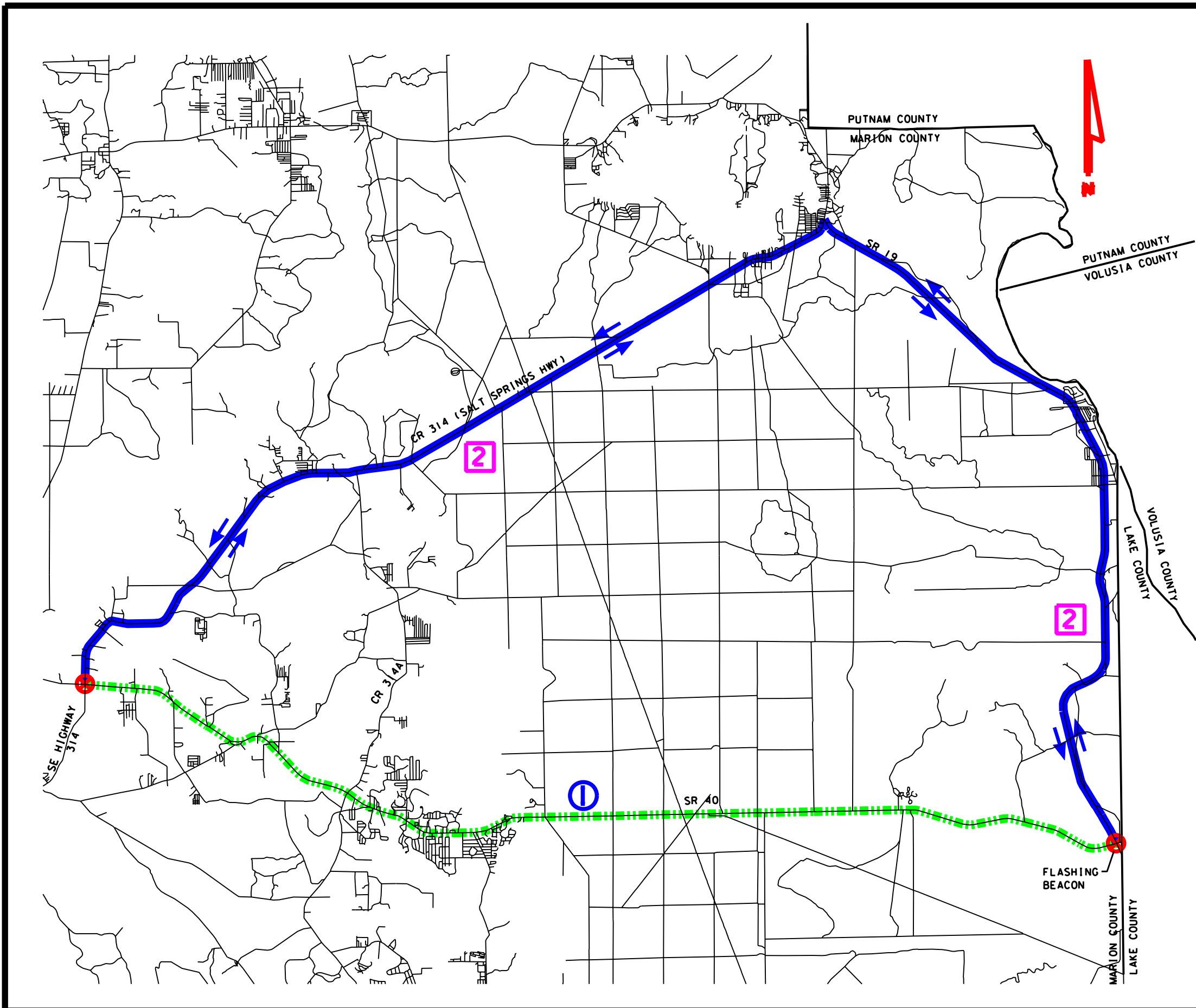

LEGEND

- - - - - CLOSED PORTION OF HIGHWAY
- — — — — PRIMARY ALTERNATE ROUTES
- - - - - SECONDARY ALTERNATE ROUTES
- 2 NUMBER OF LANES
- ⊥ INCIDENT LOCATION
- DIRECTION OF ROUTED TRAFFIC
- ⊗ SIGNALIZED INTERSECTION
- ⊥ EXISTING DETOUR SIGN
- ⊥ PROPOSED DETOUR SIGN
- PROPOSED VMS SIGN

LIMITS OF CLOSURE:
 SE HIGHWAY 314/ CR 314 TO US 19

EB SR 40 PRIMARY REROUTE:
 1) TURN LEFT ON CR 314.
 2) TURN RIGHT ON SR 19.

WB SR 40 PRIMARY REROUTE:
 1) TURN RIGHT ON SR 19.
 2) TURN LEFT ON CR 314.

NOTE: LAW ENFORCEMENT TO BE USED AT INTERSECTIONS AS NECESSARY.

REVISIONS		
DATE	BY	DESCRIPTION

ROAD CLOSURE FROM:
**SE HIGHWAY / CR 314 TO
 US 19**

TRAFFIC INCIDENT MANAGEMENT PLAN	FIGURE 7
---	--------------------

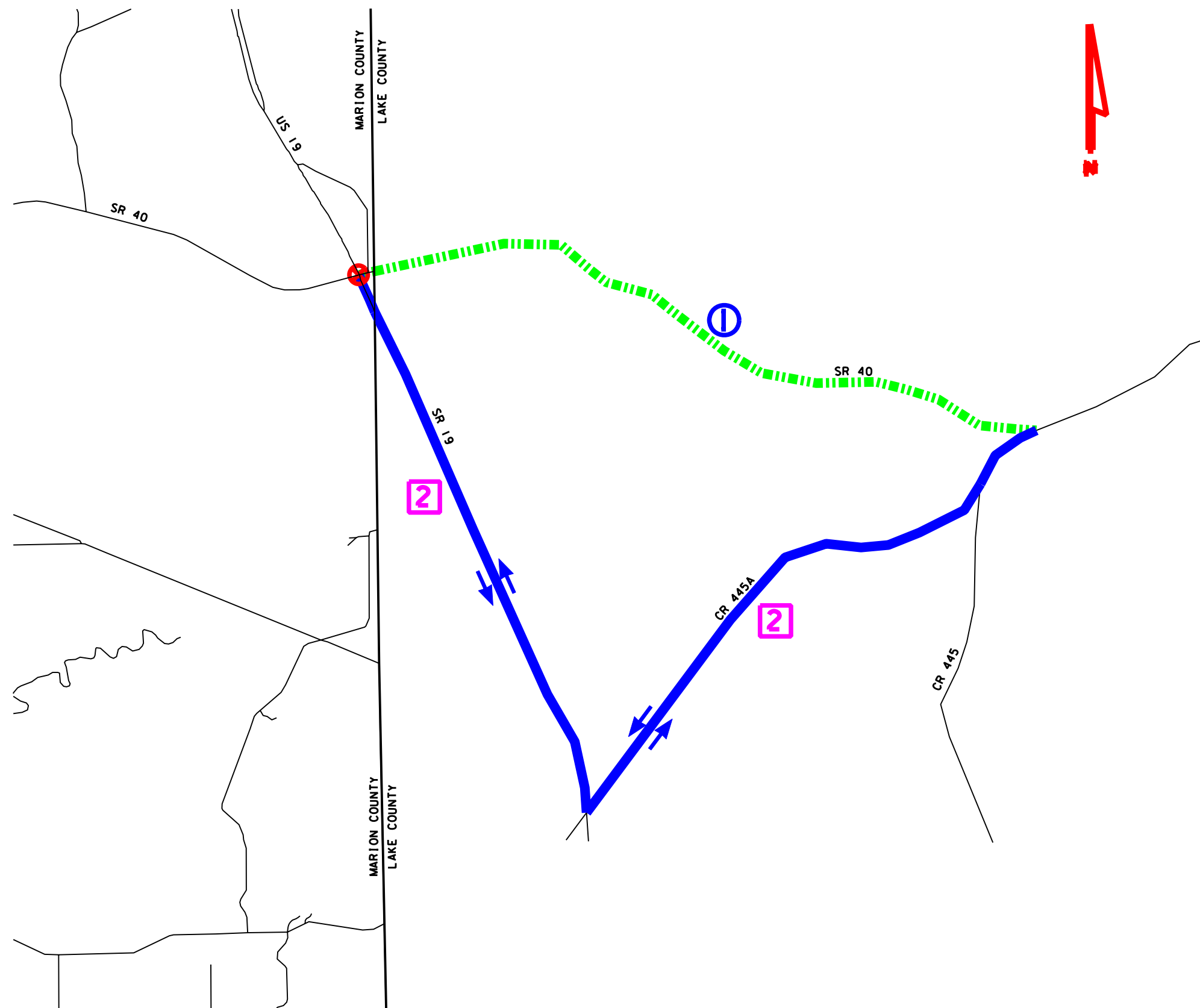

LEGEND

- ▬▬▬▬▬▬▬▬ CLOSED PORTION OF HIGHWAY
- ▬▬▬▬▬▬▬▬ PRIMARY ALTERNATE ROUTES
- ▬▬▬▬▬▬▬▬ SECONDARY ALTERNATE ROUTES
- 2 NUMBER OF LANES
- 1 INCIDENT LOCATION
- ➔ DIRECTION OF ROUTED TRAFFIC
- ⊗ SIGNALIZED INTERSECTION
- EXISTING DETOUR SIGN
- PROPOSED DETOUR SIGN
- PROPOSED VMS SIGN

LIMITS OF CLOSURE:
 SR 19 TO CR 445A

EB SR 40 PRIMARY REROUTE:
 1) TURN RIGHT ON SR 19.
 2) TURN LEFT ON CR 445A.

WB SR 40 PRIMARY REROUTE:
 1) TURN LEFT ON CR 445A.
 2) TURN RIGHT ON SR 19.

NOTE: LAW ENFORCEMENT TO BE USED AT INTERSECTIONS AS NECESSARY.

REVISIONS		
DATE	BY	DESCRIPTION

ROAD CLOSURE FROM:
US 19 TO CR 445A